

4

3

2

1

NOTES:

1. OVERALL LENGTH DEPENDENT ON FOCUS POSITION, -2MM/+3MM
2. OUTSIDE BOARD DIMENSIONS AND HOLE LOCATION TOLERANCE: +/-0.127 MM
3. REMOVABLE TRIPOD MOUNT COMPATIBLE IN ALL CONFIGURATIONS
4. MOUNTING HOLES ACCESSIBLE IN ALL CONFIGURATIONS
5. RECOMMENDED WINDOW VERTICAL TILT ANGLE: 11.5°
6. SUGGESTED DRS MOUNTING INFO: BULKHEAD MOUNT PANEL THICKNESS 0.095IN (MIN). BULKHEAD MOUNT RETAINER TORQUE 50 IN-LBS. BULKHEAD MOUNT HOLE SIZE 1.576 ± 0.03 IN. BULKHEAD O-RING 70 DUROMETER SHORE A AS568A-028
7. CENTER OF GRAVITY IS SHOWN IN APPROXIMATE LOCATIONS BASED ON MODELED VIEWS

ESTIMATED POWER DRAW IS 2.3W STEADY-STATE. CONDUCTIVE OR CONVECTIVE THERMAL DISSIPATION IS RECOMMENDED FOR ADDITIONAL CONNECTOR INFORMATION REFERENCE DRS ELECTRICAL ICD, 1040049 TENUM 1280 ELECTRICAL ICD

APPROXIMATE CENTER OF GRAVITY

21.0

39

A

1

TOP VIEW

APPROXIMATE CENTER OF GRAVITY

43.94

36.83

(19)

(22)

Ø 47.50

FRONT VIEW

REVISIONS					
ZONE	REV.	DESCRIPTION	ECO	DATE	ENGINEER
	A	INITIAL RELEASE	1883	2025-05-12	C. PRICE
	B	LM VARIANT UPDATES	1958	2026-01-02	C. PRICE

BULKHEAD LOCK RING

SENSOR ASSEMBLY

TRIPOD MOUNT

LENS

APPROXIMATE CENTER OF GRAVITY

49

Ø 43.90

(5)

(4)

3.59

10.00

14.00

RIGHT VIEW

**SL-D5-1320-A18**

VIENTO HD10 NO FEATURE BOARD, 18DEG HFOV, 40MM

MASS = 130 GRAMS

Product Export Classification Control Number(ECCN): 60/30Hz 6A003.b.4.b 9Hz: 6A993

This document does not contain export-controlled technology.

UNLESS OTHERWISE SPECIFIED DIM ARE IN MILLIMETERS

X ± 2.5 mm	ANGLES X ± 1°
X.X ± 0.3 mm	X.X ± 0.5°
X.XX ± 0.13 mm	

THIRD ANGLE PROJECTION

DO NOT SCALE DRAWING

**PROPRIETARY AND CONFIDENTIAL**  
THE INFORMATION CONTAINED IN THIS DRAWING IS THE SOLE PROPERTY OF SIERRA OLYMPIA TECHNOLOGIES, INC. ANY REPRODUCTION IN PART OR AS A WHOLE WITHOUT THE WRITTEN PERMISSION OF SIERRA OLYMPIA TECHNOLOGIES, INC. IS PROHIBITED.

MATERIAL: N/A

FINISH: N/A

N/A

**SIERRA-OLYMPIA TECHNOLOGIES INC.**

DESCRIPTION: MECHANICAL ICD, VIENTO HD10, 18DEG HFOV, 40MM

SIZE	DRAWN BY:	SHEET 1 OF 8
<b>B</b>	C. PRICE	

DRAWING NUMBER:	20-70101	Rev. B
-----------------	----------	--------

4

3

2

1

ESTIMATED POWER DRAW IS 2.5W STEADY-STATE.  
 CONDUCTIVE OR CONVECTIVE THERMAL DISSIPATION  
 IS RECOMMENDED  
 FOR ADDITIONAL CONNECTOR INFORMATION REFERENCE  
 DRS ELECTRICAL ICD, 1040049 TENUM 1280 ELECTRICAL ICD

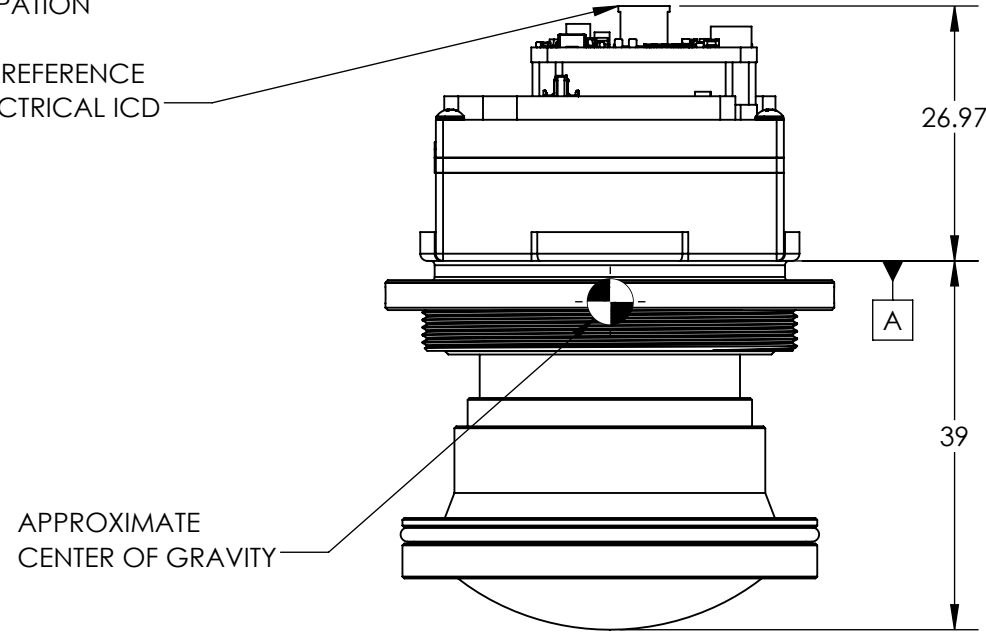

TOP VIEW

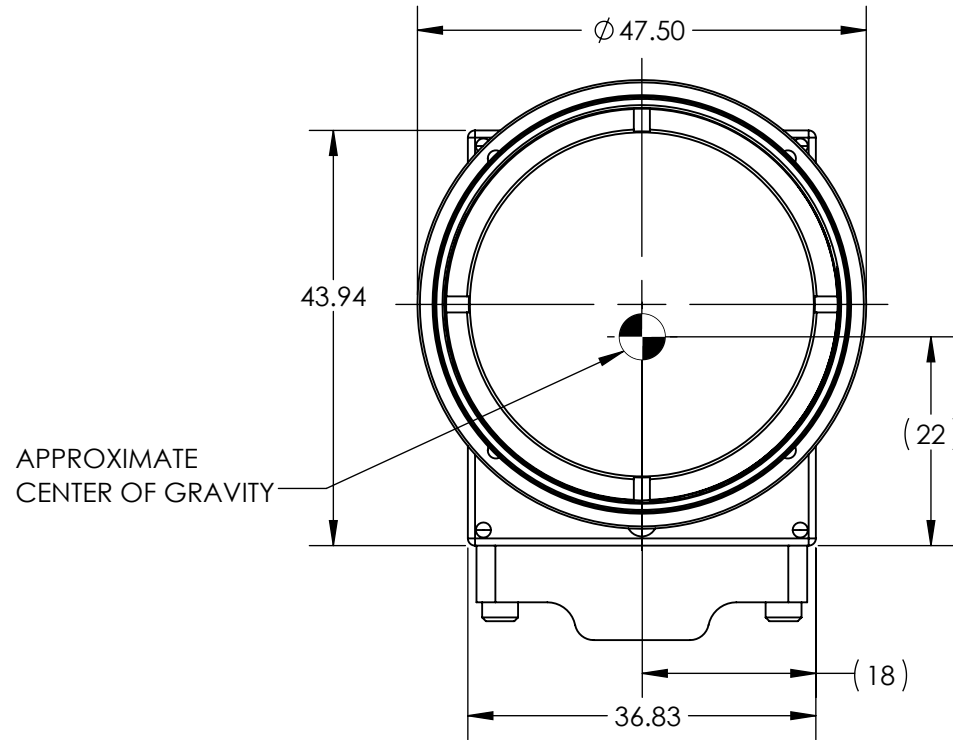
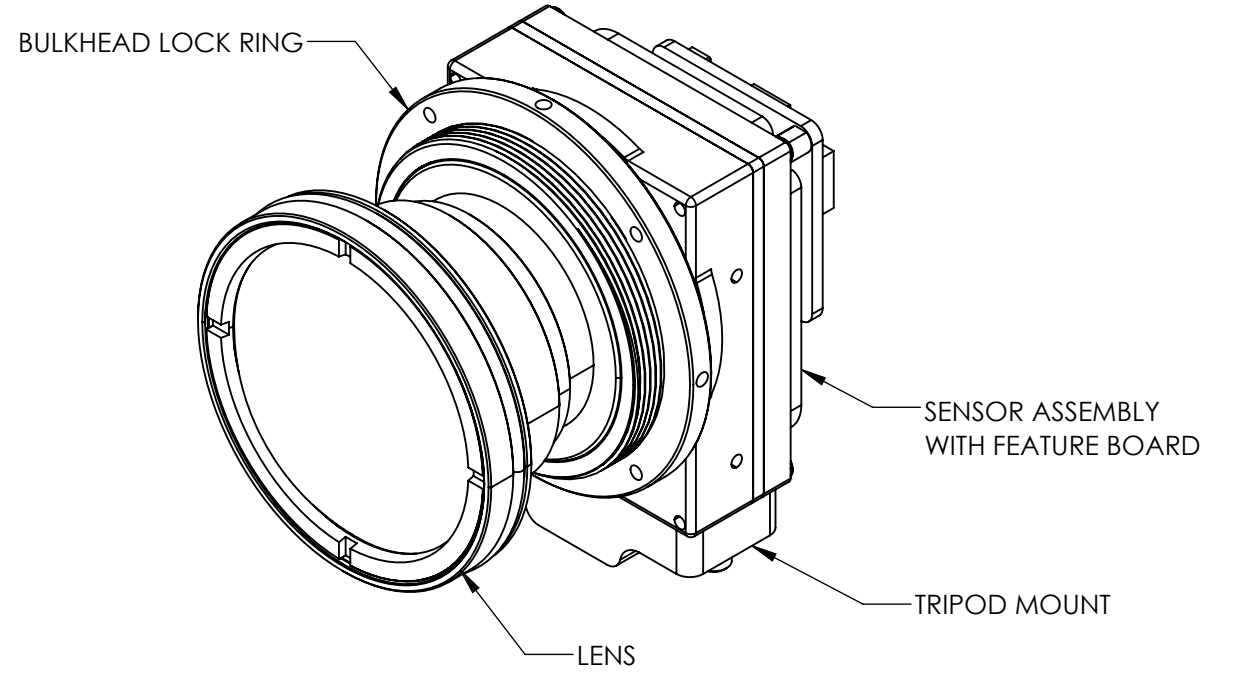

FRONT VIEW

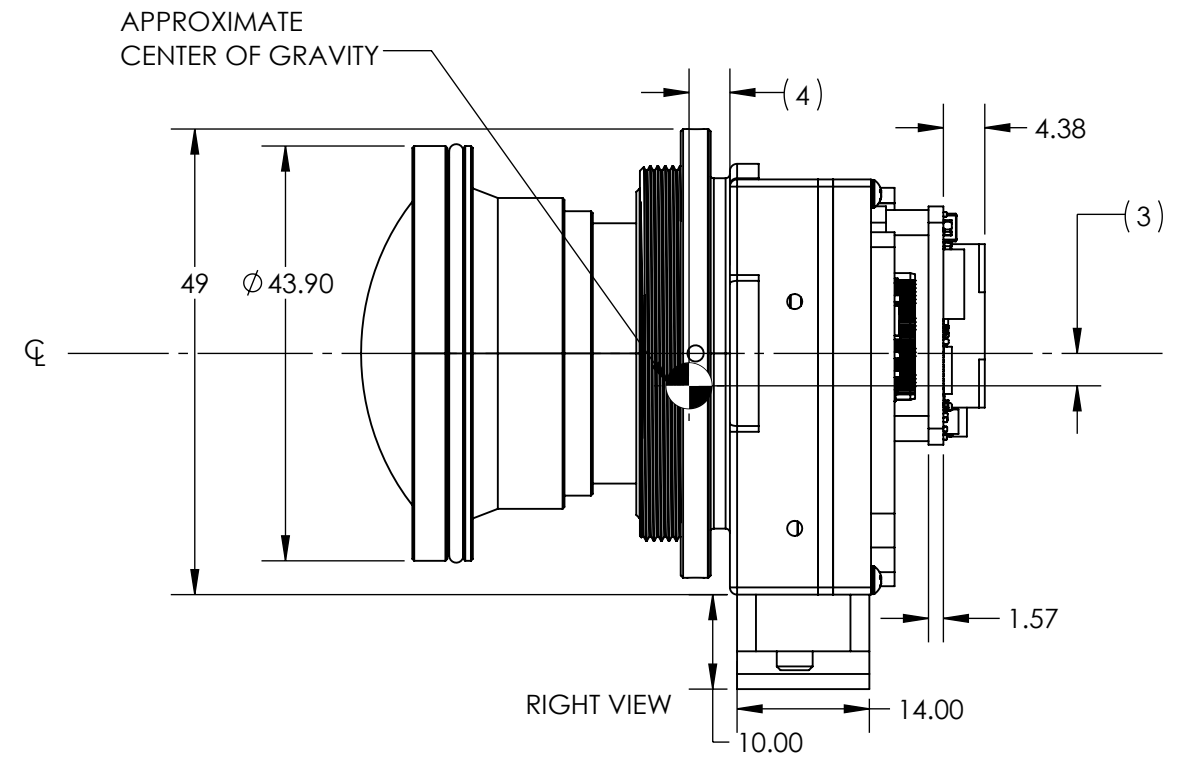

RIGHT VIEW

**SL-D5-1321-A18**  
 VIENTO HD10 WITH FEATURE BOARD, 18DEG HFOV, 40MM  
 MASS = 135 GRAMS

Product Export Classification Control Number(ECCN): 60/30Hz 6A003.b.4.b 9Hz: 6A993  This document does not contain export-controlled technology.	UNLESS OTHERWISE SPECIFIED DIM ARE IN MILLIMETERS		<b>PROPRIETARY AND CONFIDENTIAL</b> THE INFORMATION CONTAINED IN THIS DRAWING IS THE SOLE PROPERTY OF SIERRA OLYMPIA TECHNOLOGIES, INC. ANY REPRODUCTION IN PART OR AS A WHOLE WITHOUT THE WRITTEN PERMISSION OF SIERRA OLYMPIA TECHNOLOGIES, INC. IS PROHIBITED.		<b>SIERRA-OLYMPIA</b> TECHNOLOGIES INC.		
	X ± 2.5 mm	ANGLES X ± 1°					DESCRIPTION: MECHANICAL ICD, VIENTO HD10, 18DEG HFOV, 40MM
	X.X ± 0.3 mm	X.X ± 0.5°	MATERIAL: N/A		SIZE: <b>B</b>	DRAWN BY: C. PRICE	SHEET 2 OF 8
	X.XX ± 0.13 mm		FINISH: N/A		DRAWING NUMBER: 20-70101		Rev. B
THIRD ANGLE PROJECTION		DO NOT SCALE DRAWING					

ESTIMATED POWER DRAW IS 4.6W STEADY-STATE.  
 CONDUCTIVE OR CONVECTIVE THERMAL DISSIPATION  
 IS RECOMMENDED  
 FOR ADDITIONAL CONNECTOR INFORMATION REFERENCE  
 ELECTRICAL ICD DOC 20-70068

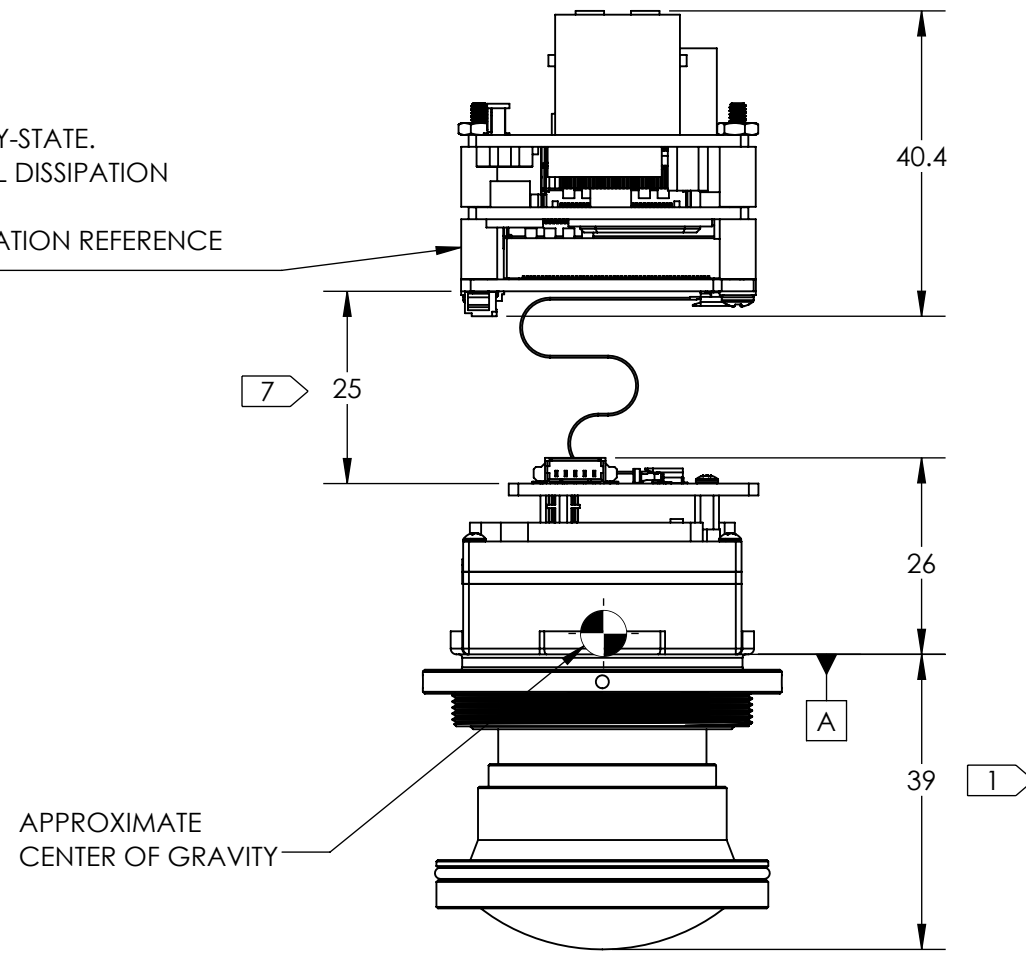

TOP VIEW

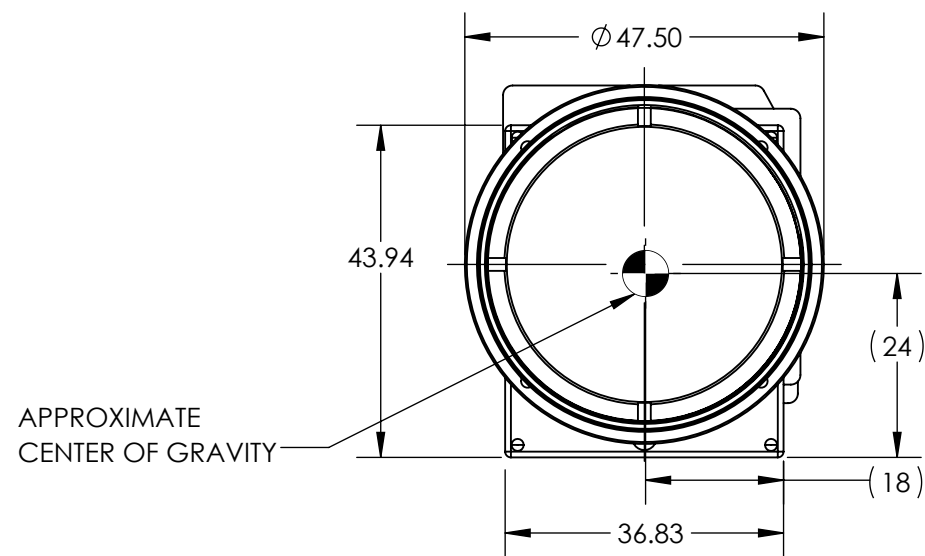

FRONT VIEW

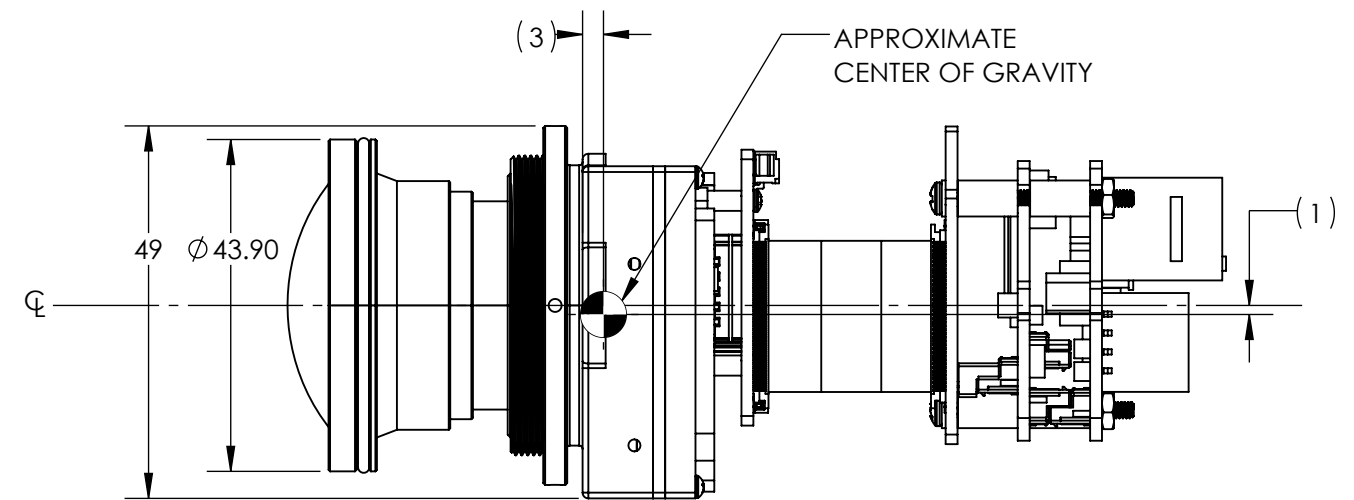
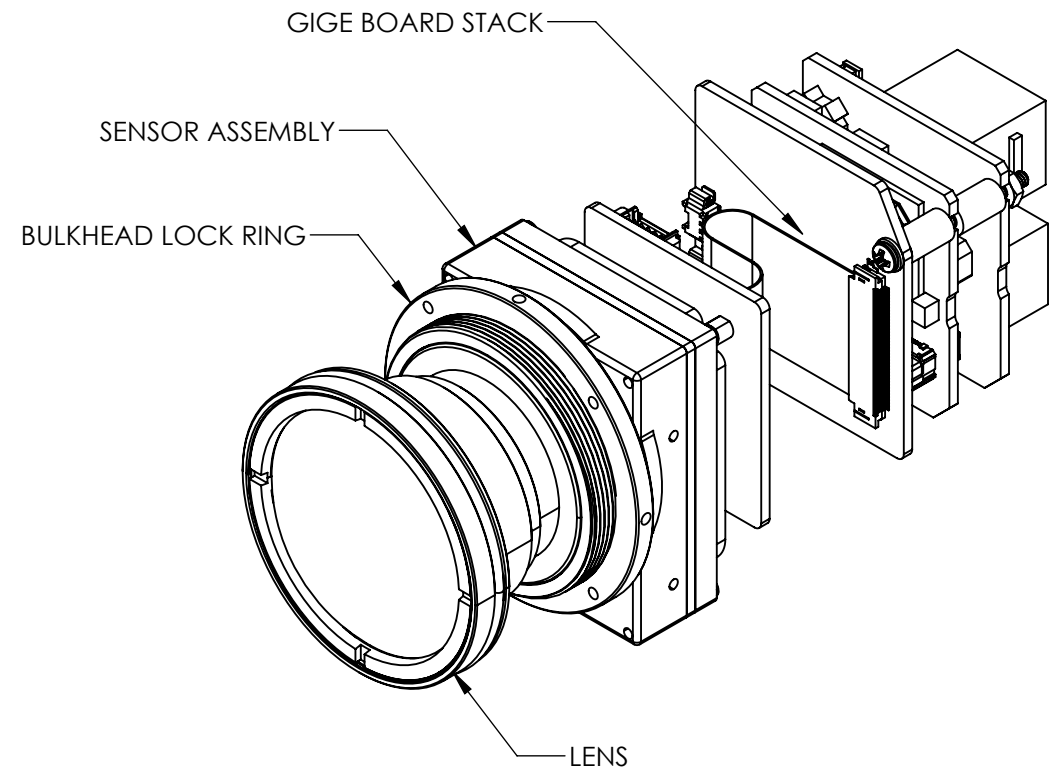

RIGHT VIEW

**SL-D5-1322-A18**  
 VIENTO HD10 GIGE, 18DEG HFOV, 40MM  
 MASS = 141 GRAMS

Product Export Classification Control Number(ECCN): 60/30Hz 6A003.b.4.b 9Hz: 6A993  This document does not contain export-controlled technology.	UNLESS OTHERWISE SPECIFIED DIM ARE IN MILLIMETERS		<b>PROPRIETARY AND CONFIDENTIAL</b> THE INFORMATION CONTAINED IN THIS DRAWING IS THE SOLE PROPERTY OF SIERRA OLYMPIA TECHNOLOGIES, INC. ANY REPRODUCTION IN PART OR AS A WHOLE WITHOUT THE WRITTEN PERMISSION OF SIERRA OLYMPIA TECHNOLOGIES, INC. IS PROHIBITED.		<b>SIERRA-OLYMPIA</b> TECHNOLOGIES INC.
	X $\pm$ 2.5 mm X.X $\pm$ 0.3 mm X.XX $\pm$ 0.13 mm	ANGLES X $\pm$ 1° X.X $\pm$ 0.5°	MATERIAL: N/A		
	THIRD ANGLE PROJECTION 		FINISH: N/A		SIZE DRAWN BY: <b>B</b> C. PRICE
	DO NOT SCALE DRAWING		N/A		DRAWING NUMBER: 20-70101

ESTIMATED POWER DRAW IS 2.5W STEADY-STATE.  
 CONDUCTIVE OR CONVECTIVE THERMAL DISSIPATION  
 IS RECOMMENDED  
 FOR ADDITIONAL CONNECTOR INFORMATION REFERENCE  
 ELECTRICAL ICD DOC S-D11285

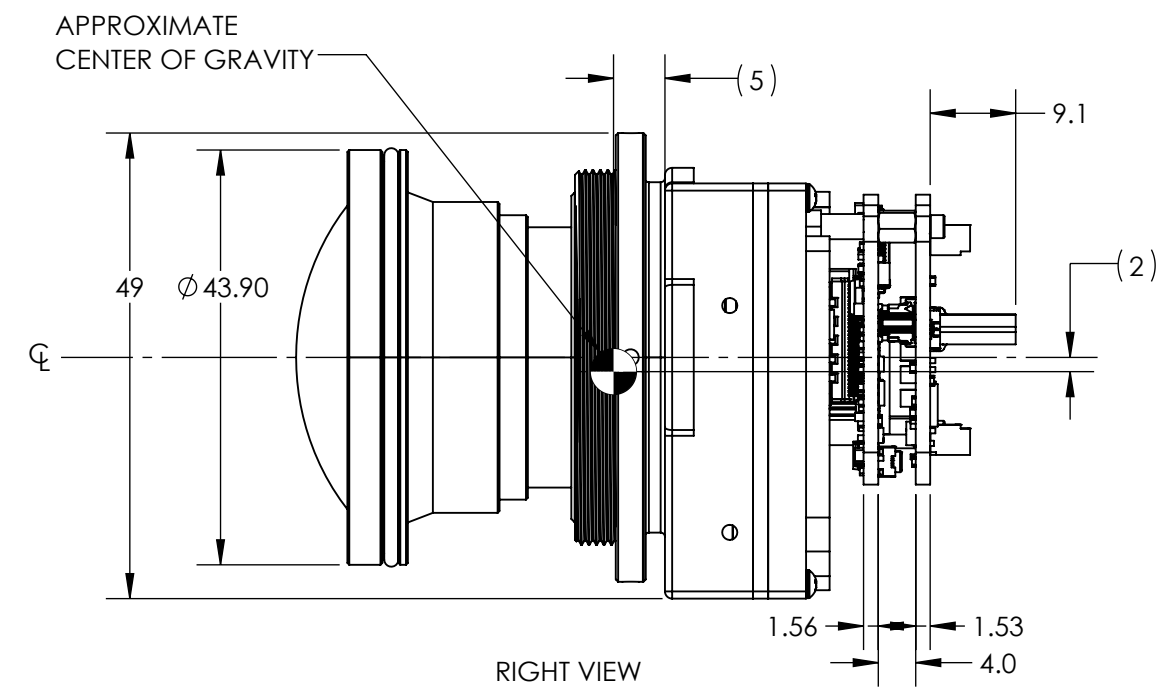
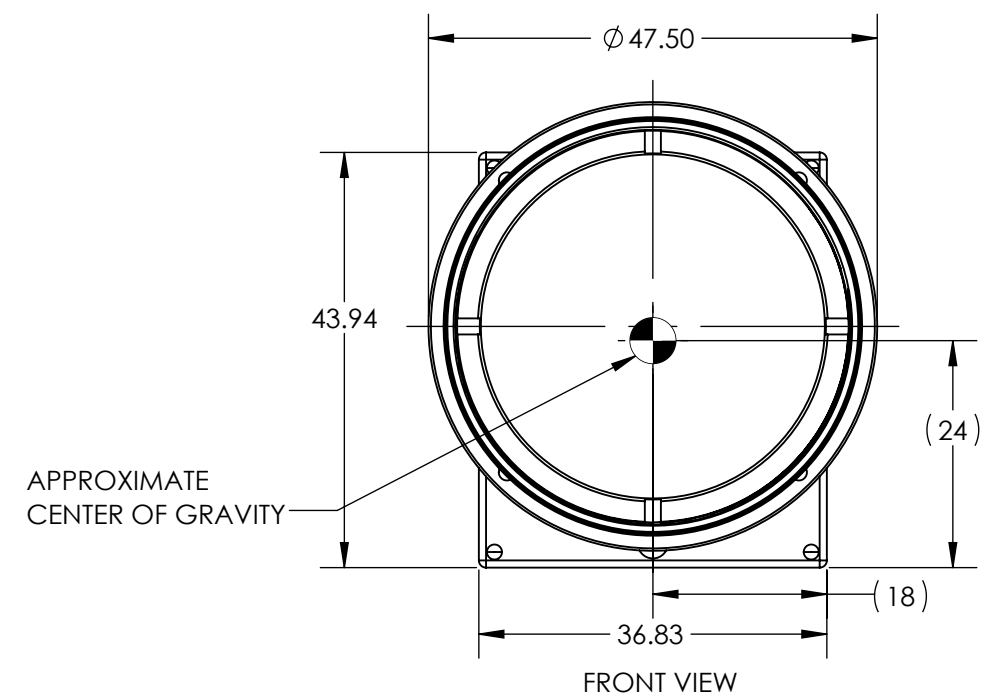
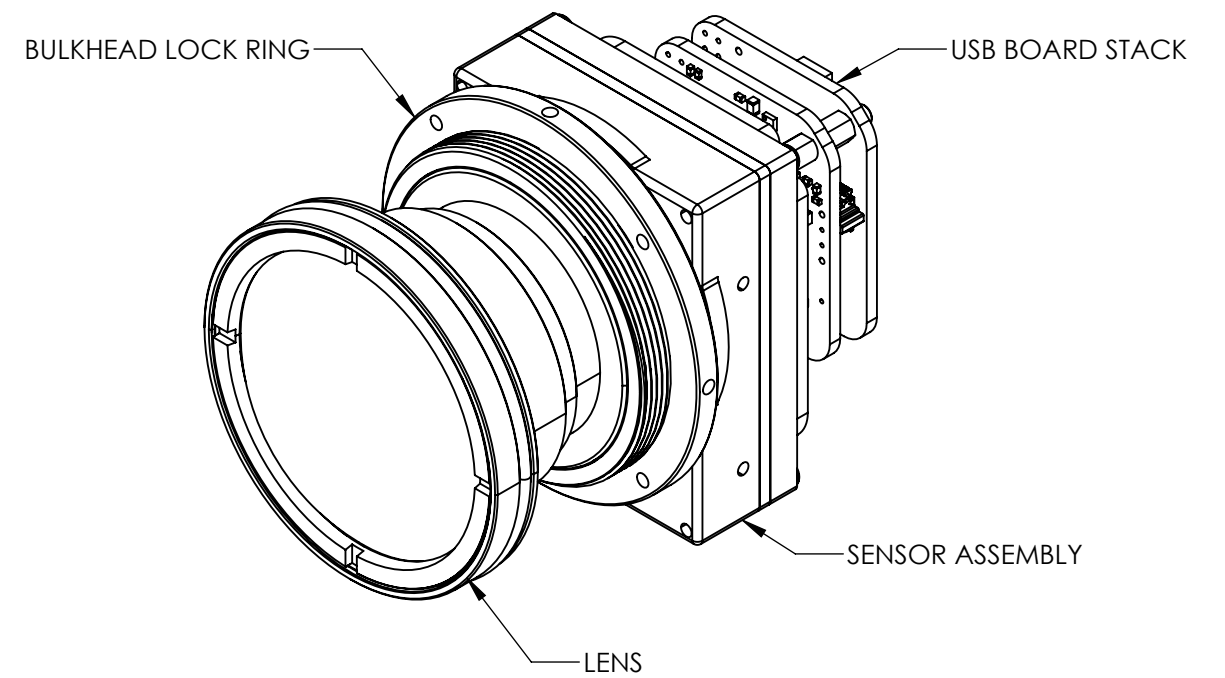
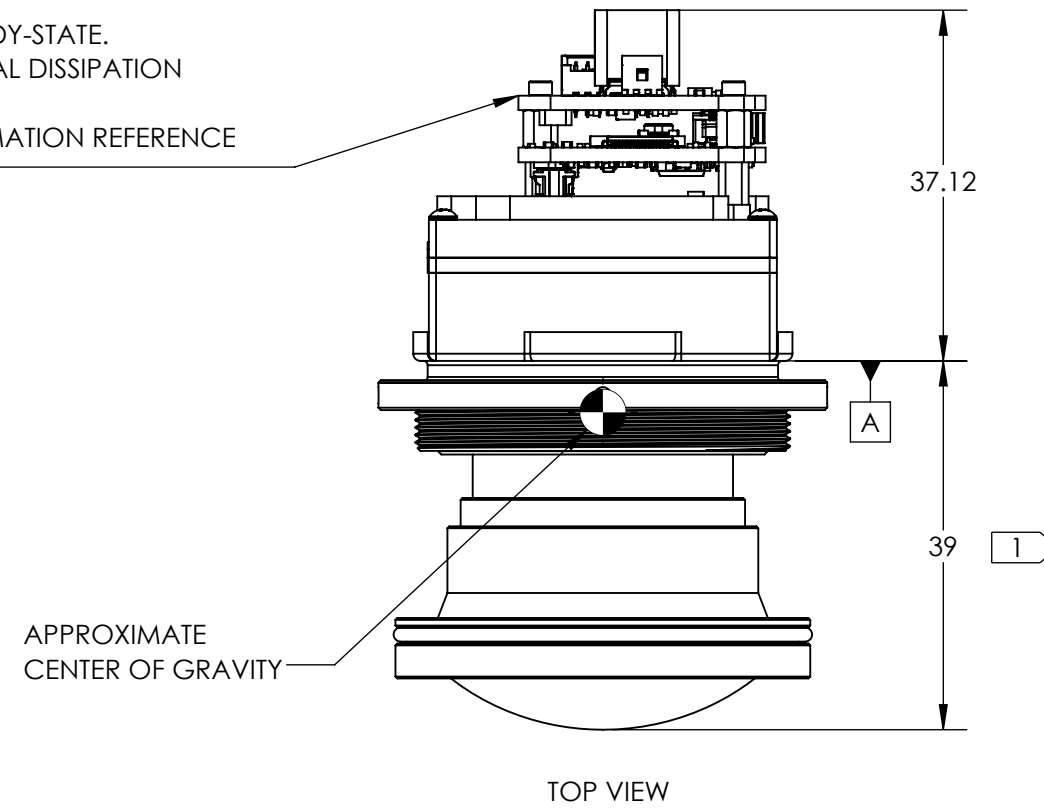

**SL-D5-1324-A18**  
 VIENTO HD10 USB, 18DEG HFOV, 40MM  
 MASS = 125 GRAMS

Product Export Classification Control Number(ECCN): 60/30Hz 6A003.b.4.b 9Hz: 6A993  This document does not contain export-controlled technology.	UNLESS OTHERWISE SPECIFIED DIM ARE IN MILLIMETERS		<b>PROPRIETARY AND CONFIDENTIAL</b> THE INFORMATION CONTAINED IN THIS DRAWING IS THE SOLE PROPERTY OF SIERRA OLYMPIA TECHNOLOGIES, INC. ANY REPRODUCTION IN PART OR AS A WHOLE WITHOUT THE WRITTEN PERMISSION OF SIERRA OLYMPIA TECHNOLOGIES, INC. IS PROHIBITED.  MATERIAL: N/A  FINISH: N/A  N/A	<b>SIERRA-OLYMPIA</b> TECHNOLOGIES INC. DESCRIPTION: MECHANICAL ICD, VIENTO HD10, 18DEG HFOV, 40MM		
	X ± 2.5 mm	ANGLES X ± 1°		SIZE	DRAWN BY:	SHEET 4 OF 8
	X.X ± 0.3 mm	X.XX ± 0.13 mm		B	C. PRICE	
	THIRD ANGLE PROJECTION			DRAWING NUMBER:		Rev. B
				20-70101		
DO NOT SCALE DRAWING						

ESTIMATED POWER DRAW IS 4.1W STEADY-STATE.  
 CONDUCTIVE OR CONVECTIVE THERMAL DISSIPATION  
 IS RECOMMENDED  
 FOR ADDITIONAL CONNECTOR INFORMATION REFERENCE  
 ELECTRICAL ICD DOC 20-70054

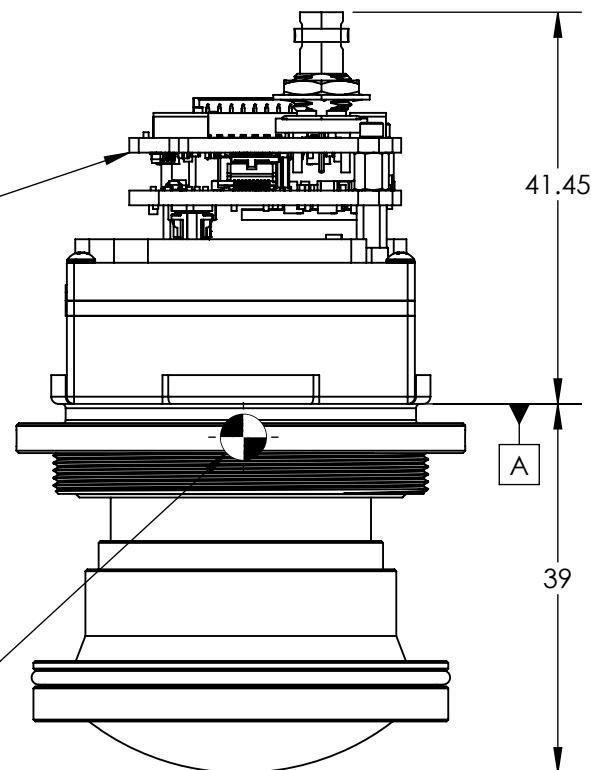

TOP VIEW

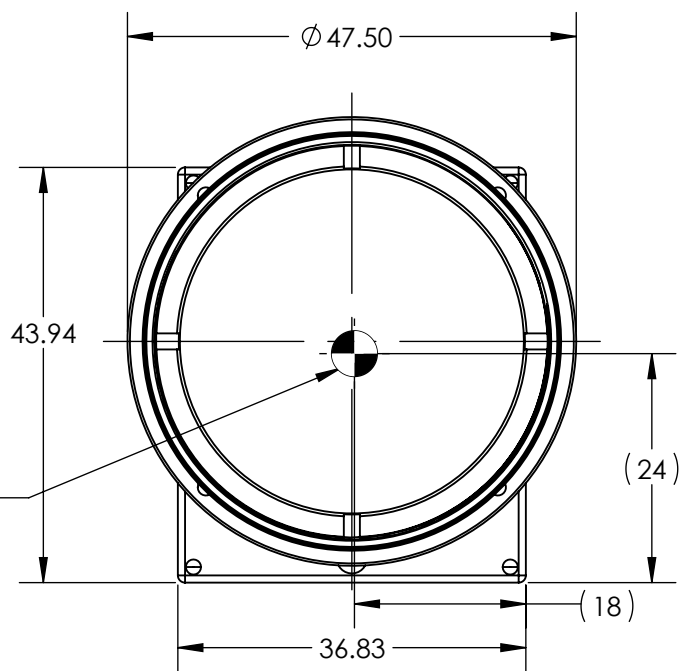
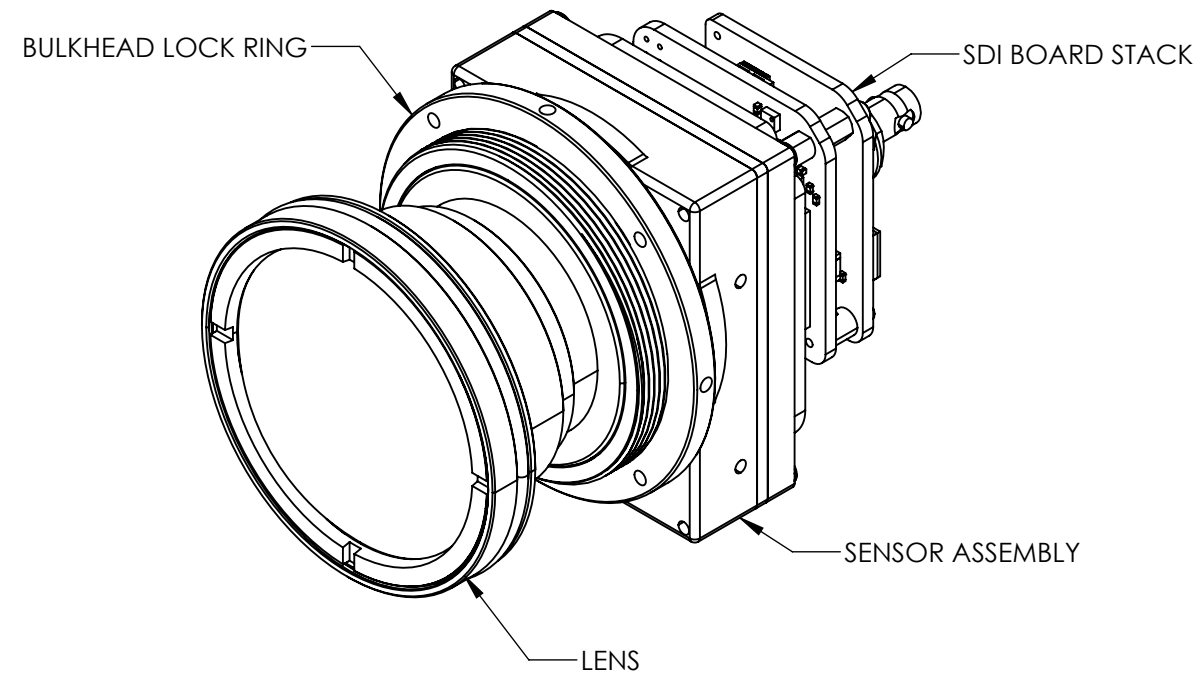

FRONT VIEW

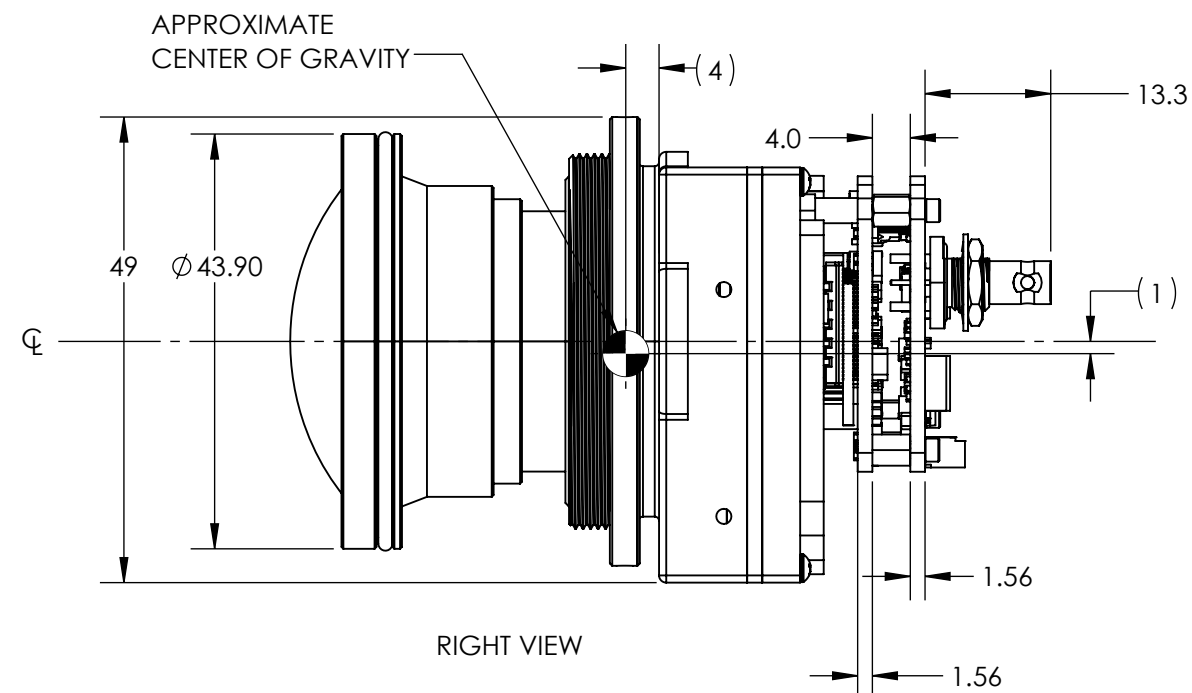

RIGHT VIEW

**SL-D5-1326-A18**  
 VIENTO HD10 SDI, 18DEG HFOV, 40MM  
 MASS = 130 GRAMS

Product Export Classification  
 Control Number(ECCN):  
 60/30Hz 6A003.b.4.b  
 9Hz: 6A993

This document does not  
 contain export-controlled  
 technology.

UNLESS OTHERWISE SPECIFIED  
 DIM ARE IN MILLIMETERS

X ± 2.5 mm	ANGLES X ± 1°
X.X ± 0.3 mm	X.X ± 0.5°
X.XX ± 0.13 mm	

THIRD ANGLE PROJECTION

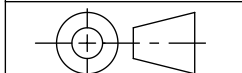

DO NOT SCALE DRAWING

**PROPRIETARY AND CONFIDENTIAL**  
 THE INFORMATION CONTAINED IN THIS DRAWING IS THE SOLE  
 PROPERTY OF SIERRA OLYMPIA TECHNOLOGIES, INC. ANY  
 REPRODUCTION IN PART OR AS A WHOLE WITHOUT THE WRITTEN  
 PERMISSION OF SIERRA OLYMPIA TECHNOLOGIES, INC. IS PROHIBITED.

MATERIAL:  
 N/A

FINISH:  
 N/A

N/A

**SIERRA-OLYMPIA**  
 TECHNOLOGIES INC.

DESCRIPTION: MECHANICAL ICD,  
 VIENTO HD10, 18DEG HFOV, 40MM

SIZE <b>B</b>	DRAWN BY: C. PRICE	SHEET 5 OF 8
------------------	-----------------------	--------------

DRAWING NUMBER: 20-70101	Rev. B
-----------------------------	--------

ESTIMATED POWER DRAW IS 3.1W STEADY-STATE.  
 CONDUCTIVE OR CONVECTIVE THERMAL DISSIPATION  
 IS RECOMMENDED  
 FOR ADDITIONAL CONNECTOR INFORMATION REFERENCE  
 ELECTRICAL ICD DOC 20-70060

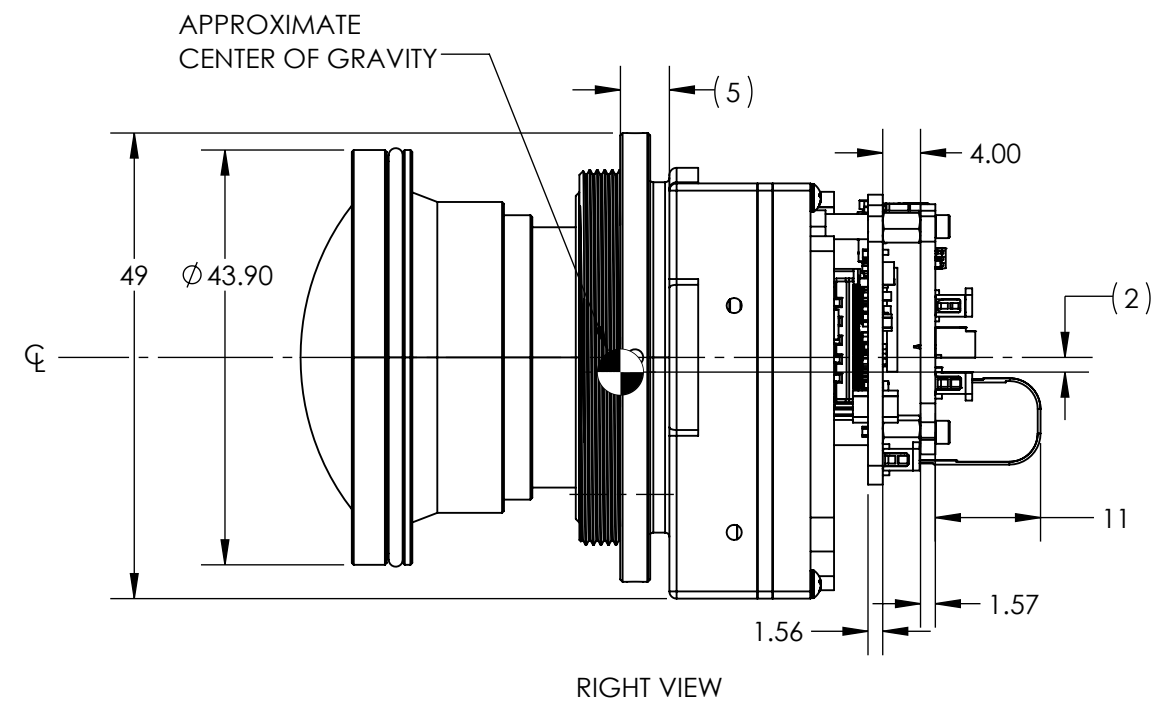
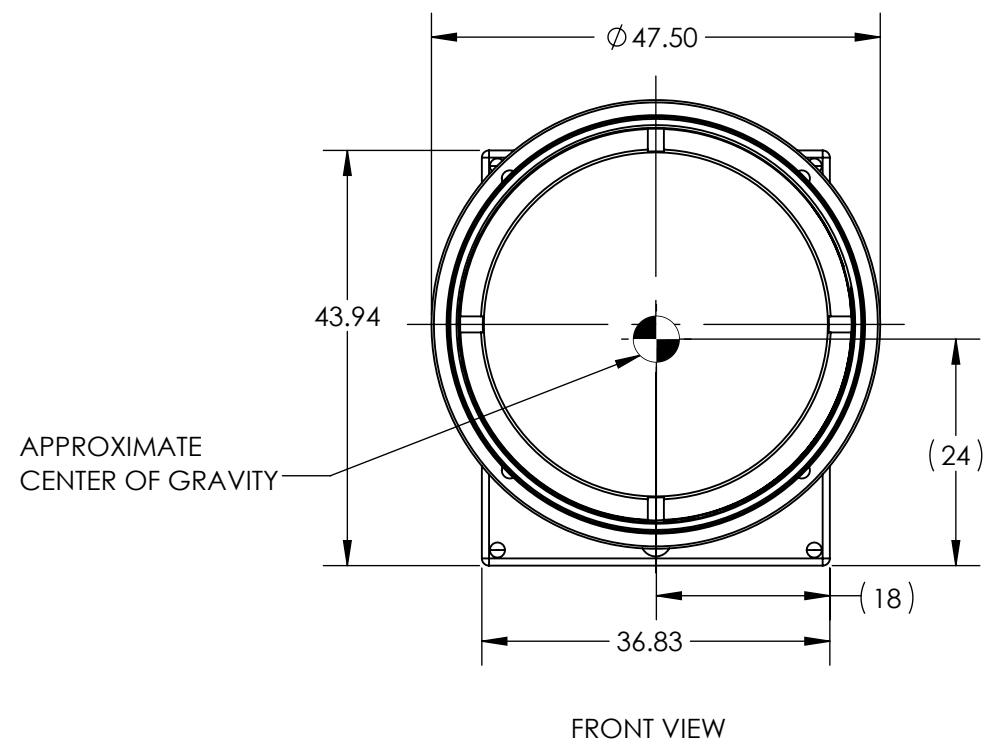
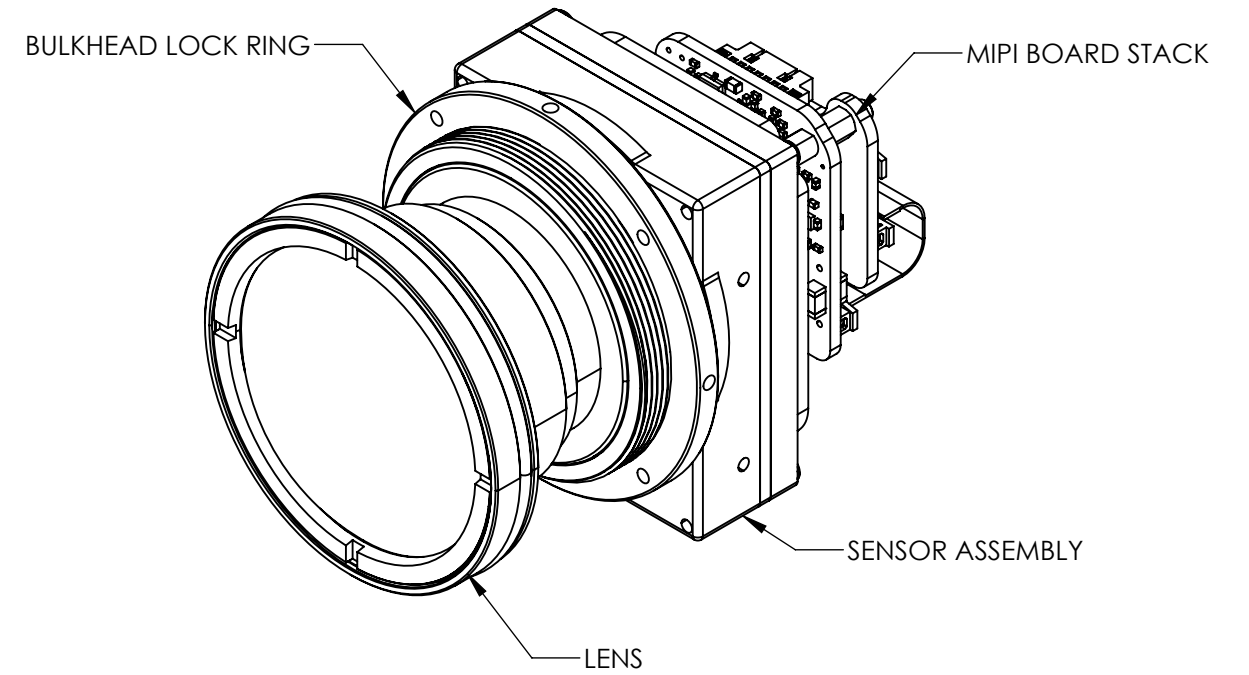
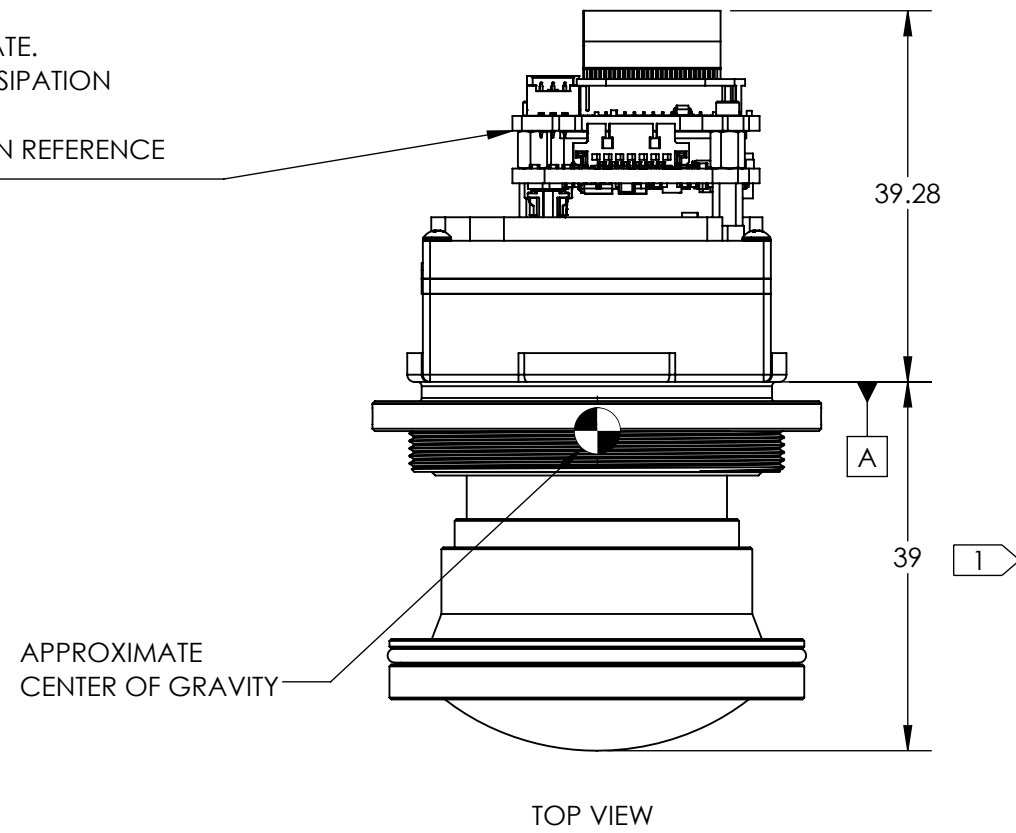

**SL-D5-1328-A18**  
 VIENTO HD10 MIPI, 18DEG HFOV, 40MM  
 MASS = 125 GRAMS

Product Export Classification  
 Control Number(ECCN):  
 60/30Hz 6A003.b.4.b  
 9Hz: 6A993

This document does not  
 contain export-controlled  
 technology.

UNLESS OTHERWISE SPECIFIED  
 DIM ARE IN MILLIMETERS

X ± 2.5 mm	ANGLES X ± 1°
X.X ± 0.3 mm	X.X ± 0.5°
X.XX ± 0.13 mm	

THIRD ANGLE PROJECTION

DO NOT SCALE DRAWING

**PROPRIETARY AND CONFIDENTIAL**  
 THE INFORMATION CONTAINED IN THIS DRAWING IS THE SOLE  
 PROPERTY OF SIERRA OLYMPIA TECHNOLOGIES, INC. ANY  
 REPRODUCTION IN PART OR AS A WHOLE WITHOUT THE WRITTEN  
 PERMISSION OF SIERRA OLYMPIA TECHNOLOGIES, INC. IS PROHIBITED.

MATERIAL:  
N/A

FINISH:  
N/A

N/A

**SIERRA-OLYMPIA**  
 TECHNOLOGIES INC.

DESCRIPTION: MECHANICAL ICD,  
 VIENTO HD10, 18DEG HFOV, 40MM

SIZE <b>B</b>	DRAWN BY: C. PRICE	SHEET 6 OF 8
DRAWING NUMBER: 20-70101		Rev. B

O RING GROOVE  
M34 X 0.5-6H  
INTERNAL THREAD

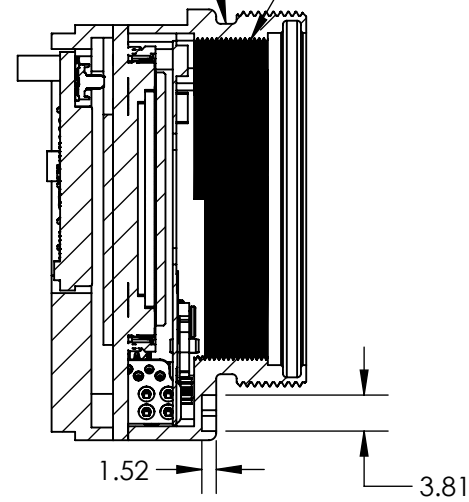

SECTION A-A  
SCALE 1.25 : 1

NOTE: REMOVAL OF BULKHEAD LOCKRING  
REQUIRES REMOVAL AND REINSTALLATION  
OF LENS. FOD RISK

4 4X M2 X 0.4-6H  $\nabla$  3.0

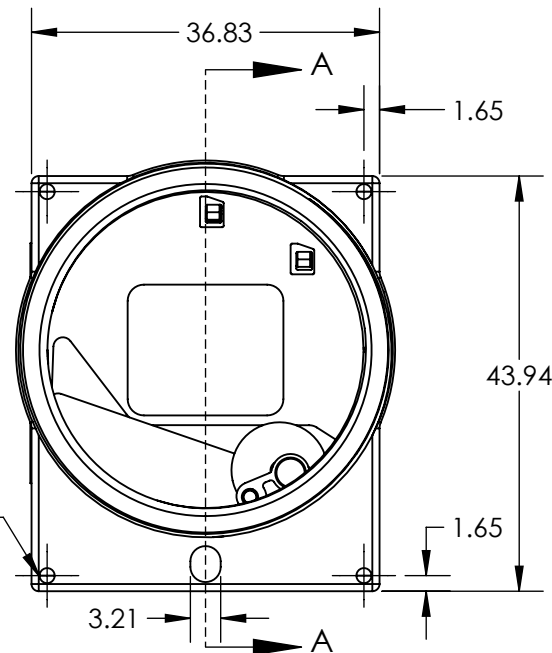

FRONT VIEW (LENS AND LOCKRING REMOVED FOR CLARITY)

2X 0.60-80 UNF-2B  $\nabla$  2.71

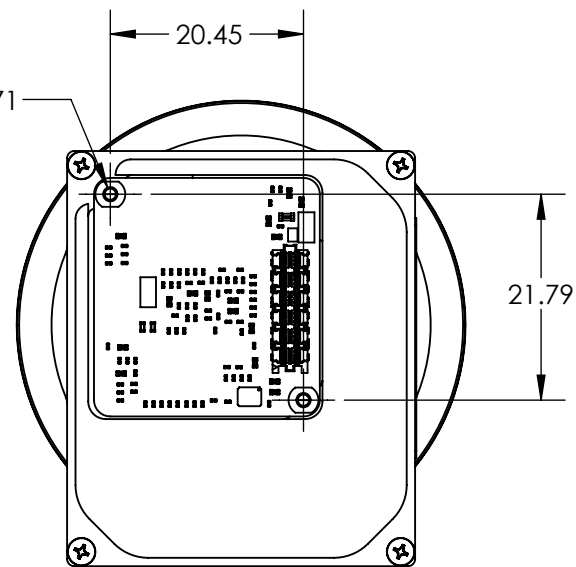

BACK VIEW

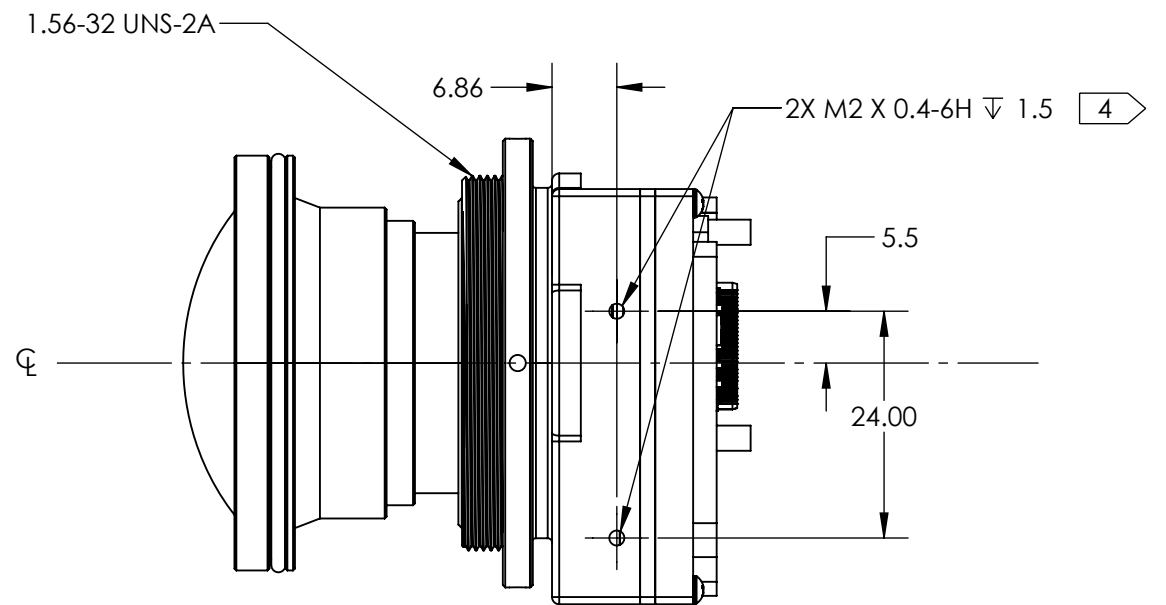

RIGHT VIEW

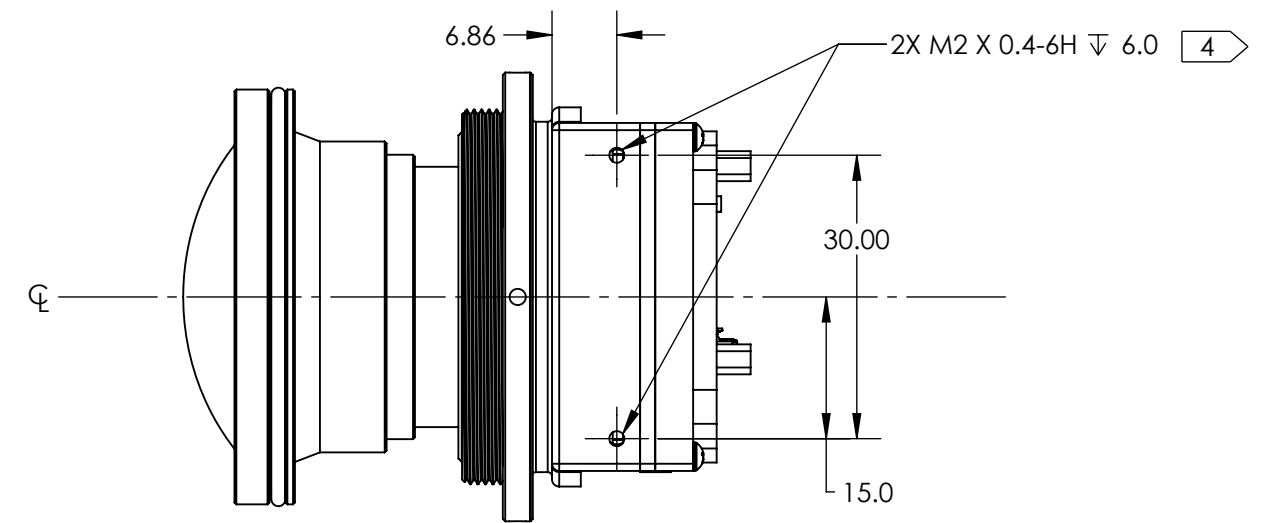

BOTTOM VIEW

Product Export Classification  
Control Number(ECCN):  
60/30Hz 6A003.b.4.b  
9Hz: 6A993  
  
This document does not  
contain export-controlled  
technology.

UNLESS OTHERWISE SPECIFIED  
DIM ARE IN MILLIMETERS  
X  $\pm$  2.5 mm      ANGLES  
X.X  $\pm$  0.3 mm      X  $\pm$  1°  
X.XX  $\pm$  0.13 mm    X.X  $\pm$  0.5°

THIRD ANGLE PROJECTION

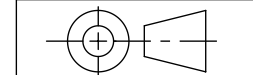

DO NOT SCALE DRAWING

**PROPRIETARY AND CONFIDENTIAL**  
THE INFORMATION CONTAINED IN THIS DRAWING IS THE SOLE  
PROPERTY OF SIERRA OLYMPIA TECHNOLOGIES, INC. ANY  
REPRODUCTION IN PART OR AS A WHOLE WITHOUT THE WRITTEN  
PERMISSION OF SIERRA OLYMPIA TECHNOLOGIES, INC. IS PROHIBITED.

MATERIAL:  
N/A

FINISH:  
N/A

N/A

**SIERRA-OLYMPIA**  
TECHNOLOGIES INC.

DESCRIPTION: MECHANICAL ICD,  
VIENTO HD10, 18DEG HFOV, 40MM

SIZE: **B**    DRAWN BY: C. PRICE    SHEET 7 OF 8

DRAWING NUMBER: 20-70101    Rev. B

4

3

2

1

REMOVABLE LENS CAP  
PN: 80-20254

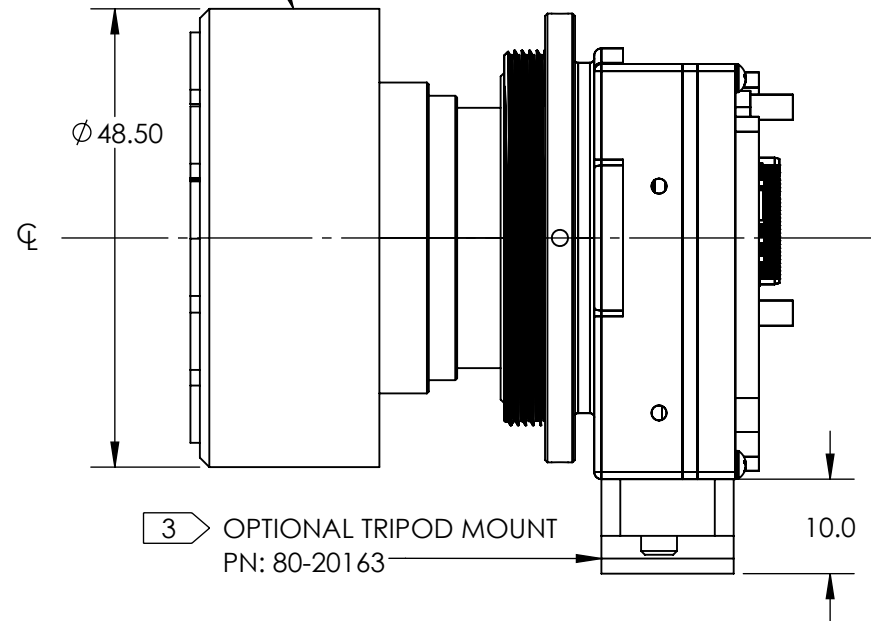

RIGHT VIEW WITH OPTIONAL TRIPOD MOUNT AND REMOVABLE LENS CAP

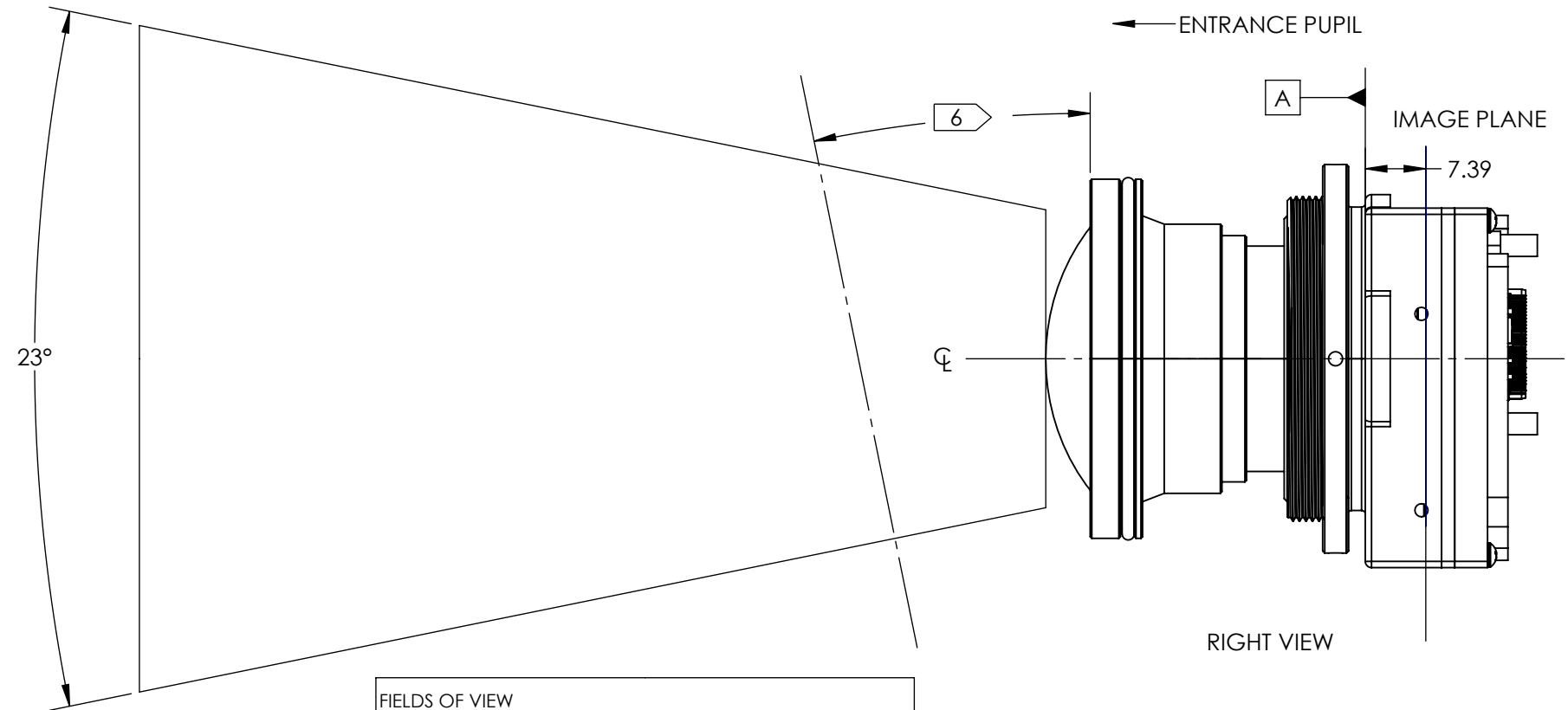

FIELDS OF VIEW	
ENTRANCE PUPIL LOCATION AT LENS VERTEX	
ENTRANCE PUPIL DIAMETER: 36.42MM	
VFOV	14.5°
HFOV	18.0°
DFOV	23.0°

ENTRANCE PUPIL

A

IMAGE PLANE

6

Ø 48.50

10.0

3 OPTIONAL TRIPOD MOUNT  
PN: 80-20163

23°

6

7.39

RIGHT VIEW

REMOVABLE GIGE SHIPPING BRACKET  
PN: 80-20257

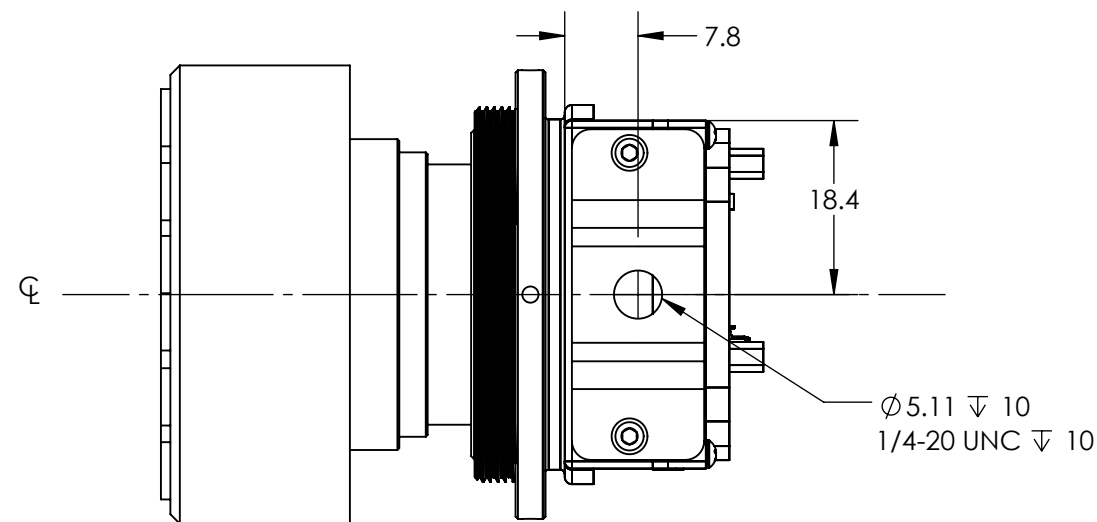

BOTTOM VIEW WITH OPTIONAL TRIPOD MOUNT AND REMOVABLE LENS CAP

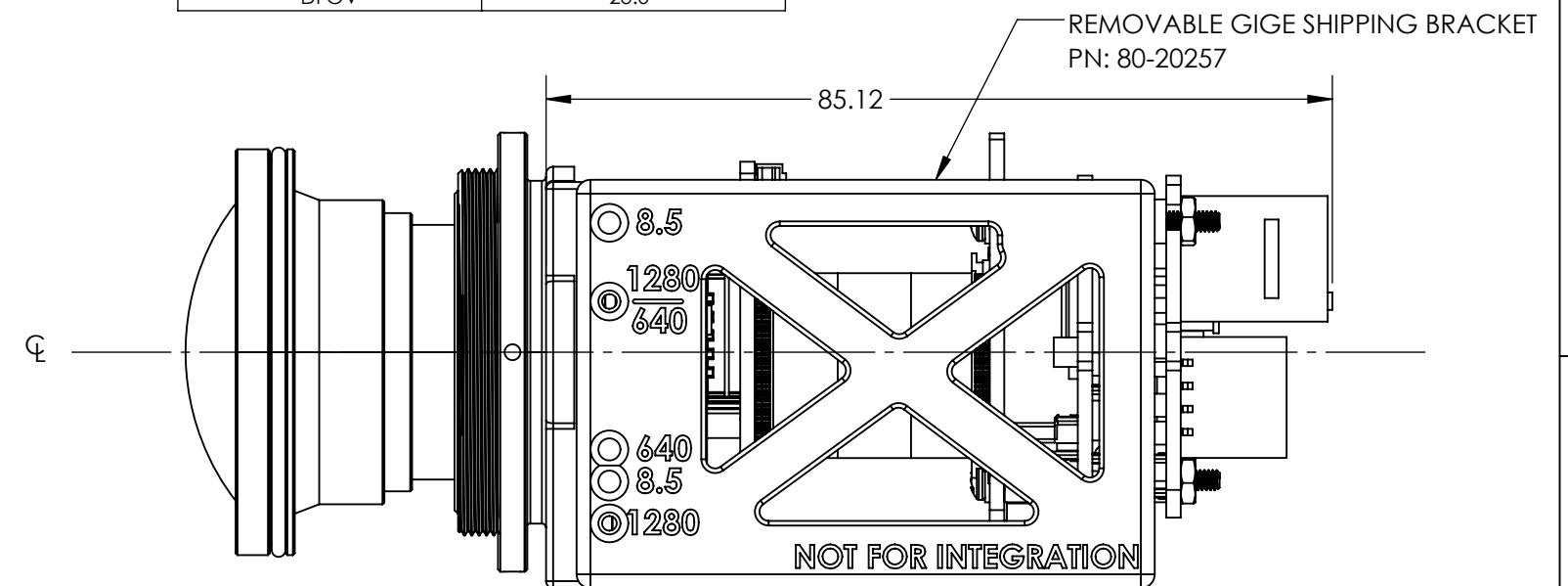

RIGHT VIEW WITH REMOVABLE GIGE SHIPPING BRACKET

Product Export Classification  
Control Number(ECCN):  
60/30Hz 6A003.b.4.b  
9Hz: 6A993

This document does not  
contain export-controlled  
technology.

UNLESS OTHERWISE SPECIFIED  
DIM ARE IN MILLIMETERS

X ± 2.5 mm	ANGLES
X.X ± 0.3 mm	X ± 1°
X.XX ± 0.13 mm	X.X ± 0.5°

THIRD ANGLE PROJECTION

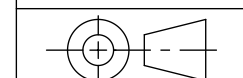

DO NOT SCALE DRAWING

**PROPRIETARY AND CONFIDENTIAL**  
THE INFORMATION CONTAINED IN THIS DRAWING IS THE SOLE  
PROPERTY OF SIERRA OLYMPIA TECHNOLOGIES, INC. ANY  
REPRODUCTION IN PART OR AS A WHOLE WITHOUT THE WRITTEN  
PERMISSION OF SIERRA OLYMPIA TECHNOLOGIES, INC. IS PROHIBITED.

MATERIAL:  
N/A

FINISH:  
N/A

N/A

**SIERRA-OLYMPIA**  
TECHNOLOGIES INC.

DESCRIPTION: MECHANICAL ICD,  
VIENTO HD10, 18DEG HFOV, 40MM

SIZE: **B** DRAWN BY: C. PRICE SHEET 8 OF 8

DRAWING NUMBER: 20-70101 Rev. B

4

3

2

1