

NOTES:

- 1. OVERALL LENGTH DEPENDENT ON FOCUS POSITION, -2MM/+3MM
- 2. OUTSIDE BOARD DIMENSIONS AND HOLE LOCATION TOLERANCE: +/-0.127 MM
- 3. OPTIONAL TRIPOD MOUNT COMPATIBLE IN ALL CONFIGURATIONS
- 4. MOUNTING HOLES ACCESSIBLE IN ALL CONFIGURATIONS. EXCEEDING INDICATED DEPTH MAY RESULT DAMAGE TO CAMERA.
- 5. RECOMMENDED WINDOW VERTICAL TILT ANGLE: 29° WILL ELIMINATE NARCISSUS. SHALLOWER ANGLES MAY BE MORE PRACTICAL BUT WILL REQUIRE TESTING TO DETERMINE ACCEPTABILITY.
- 6. SUGGESTED DRS MOUNTING INFO: BULKHEAD MOUNT PANEL THICKNESS 0.095IN (MIN). BULKHEAD MOUNT RETAINER TORQUE 50 IN-LBS. BULKHEAD MOUNT HOLE SIZE 1.576 ± 0.03 IN. BULKHEAD O-RING 70 DUROMETER SHORE A AS568A-028

ESTIMATED POWER DRAW IS 2.3W STEADY-STATE.
 CONDUCTIVE OR CONVECTIVE THERMAL DISSIPATION IS RECOMMENDED
 FOR ADDITIONAL CONNECTOR INFORMATION REFERENCE DRS ELECTRICAL ICD, 1040049 TENUM 1280 ELECTRICAL ICD

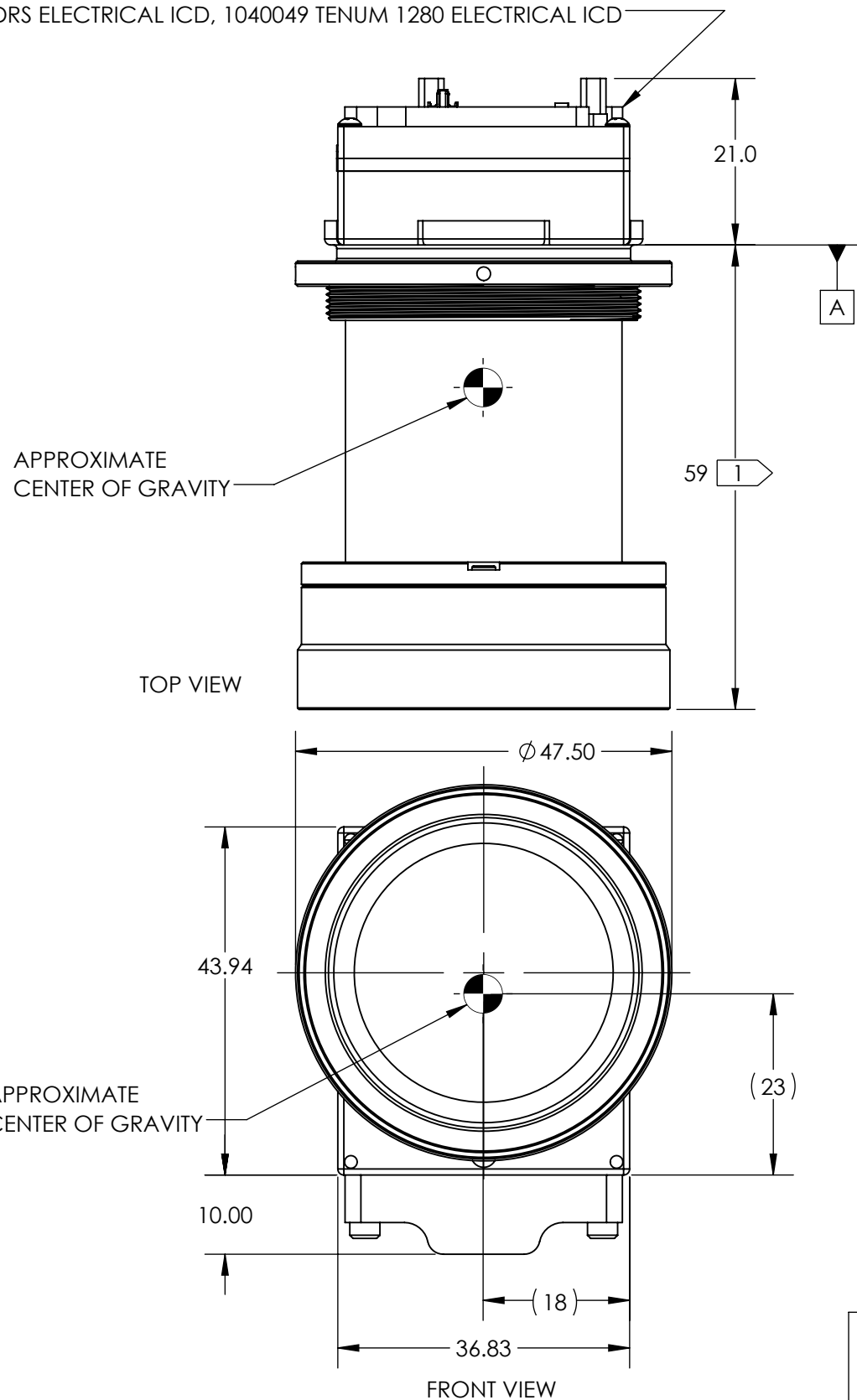

REVISIONS					
ZONE	REV.	DESCRIPTION	ECO	DATE	ENGINEER
	A	INITIAL RELEASE	1977	2026-03-06	M. SCOTT

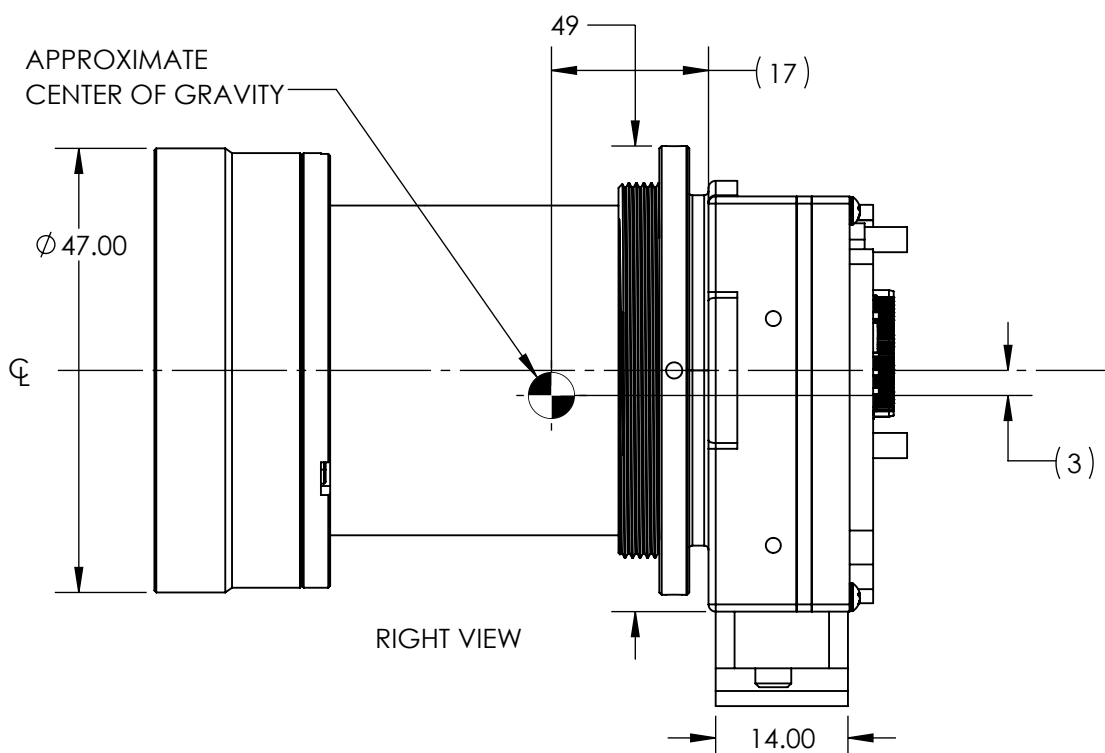
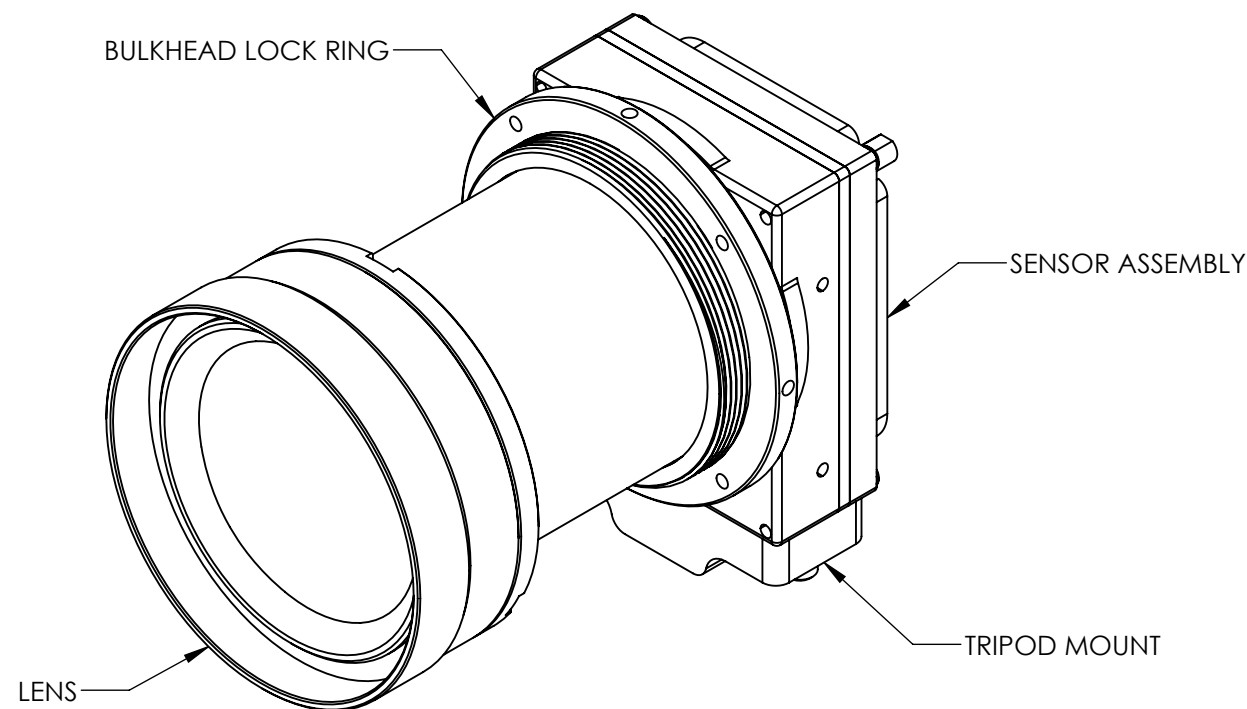

SL-D5-1320-A70

VIENTO HD10 NO FEATURE BOARD, LM, 70DEG HFOV, 9.2MM

MASS = 182 GRAMS

Product Export Classification Control Number(ECCN): 60/30Hz 6A003.b.4.b 9Hz: 6A993
 This document does not contain export-controlled technology.

UNLESS OTHERWISE SPECIFIED DIM ARE IN MILLIMETERS	
X ± 2.5 mm	ANGLES X ± 1°
X.X ± 0.3 mm	X.X ± 0.5°
X.XX ± 0.13 mm	
THIRD ANGLE PROJECTION	
DO NOT SCALE DRAWING	

PROPRIETARY AND CONFIDENTIAL
 THE INFORMATION CONTAINED IN THIS DRAWING IS THE SOLE PROPERTY OF SIERRA OLYMPIA TECHNOLOGIES, INC. ANY REPRODUCTION IN PART OR AS A WHOLE WITHOUT THE WRITTEN PERMISSION OF SIERRA OLYMPIA TECHNOLOGIES, INC. IS PROHIBITED.

MATERIAL: N/A
 FINISH: N/A



DESCRIPTION: MECHANICAL ICD, VIENTO HD10, 70DEG HFOV, 9.2mm	
SIZE B	DRAWN BY: M. SCOTT
DRAWING NUMBER: 20-70114	SHEET 1 OF 8 Rev. A

ESTIMATED POWER DRAW IS 2.5W STEADY-STATE.
 CONDUCTIVE OR CONVECTIVE THERMAL DISSIPATION
 IS RECOMMENDED
 FOR ADDITIONAL CONNECTOR INFORMATION REFERENCE
 DRS ELECTRICAL ICD, 1040049 TENUM 1280 ELECTRICAL ICD

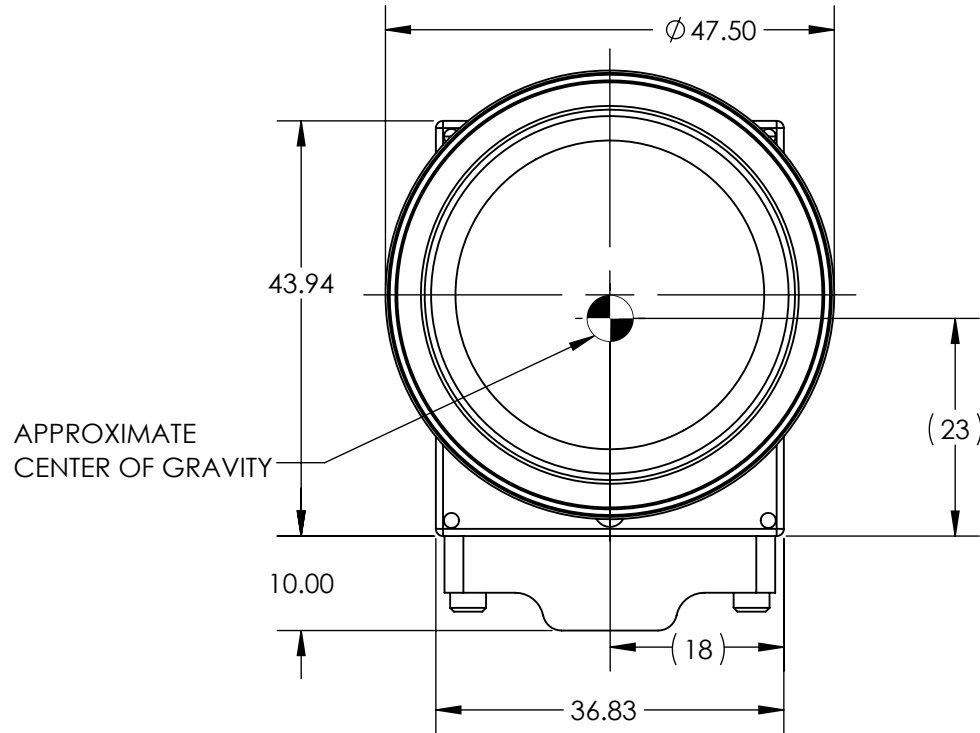
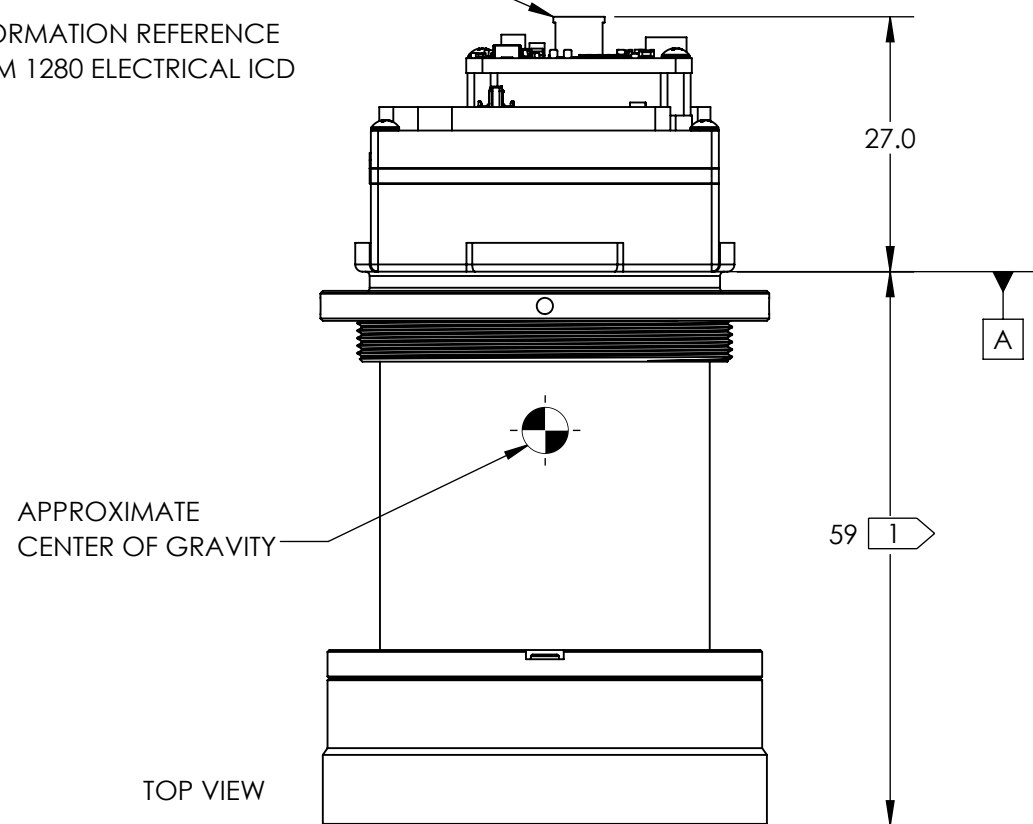

FRONT VIEW

TOP VIEW

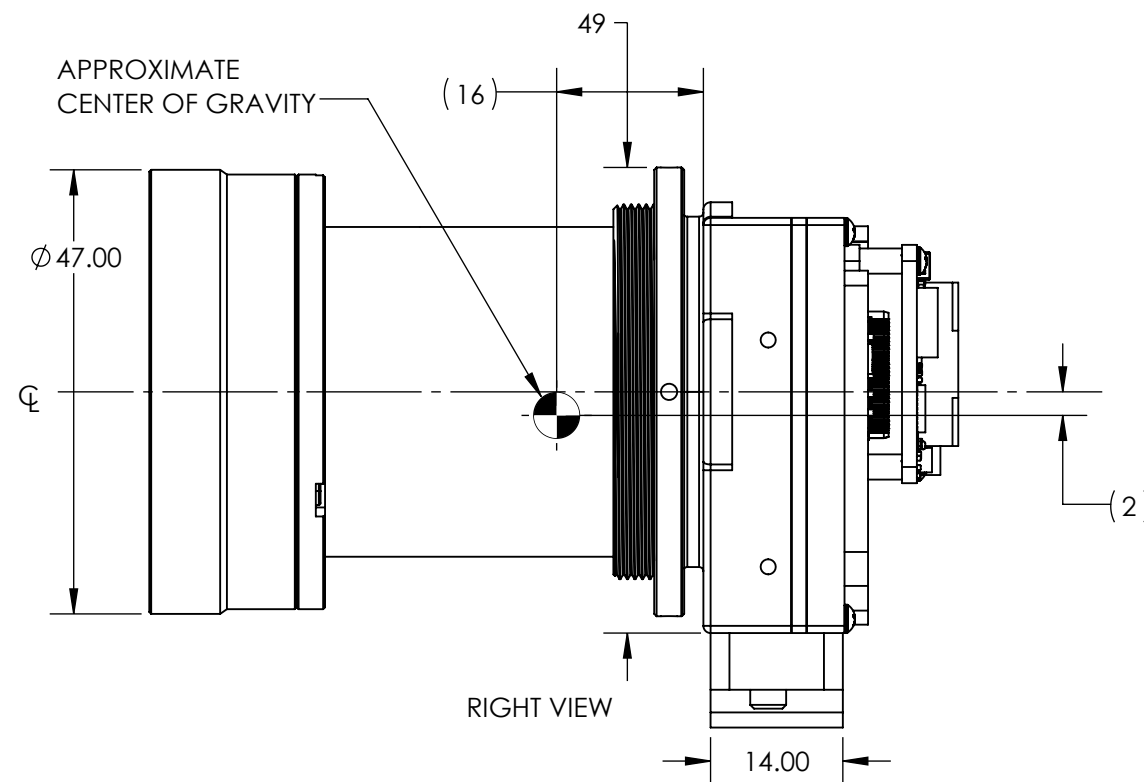
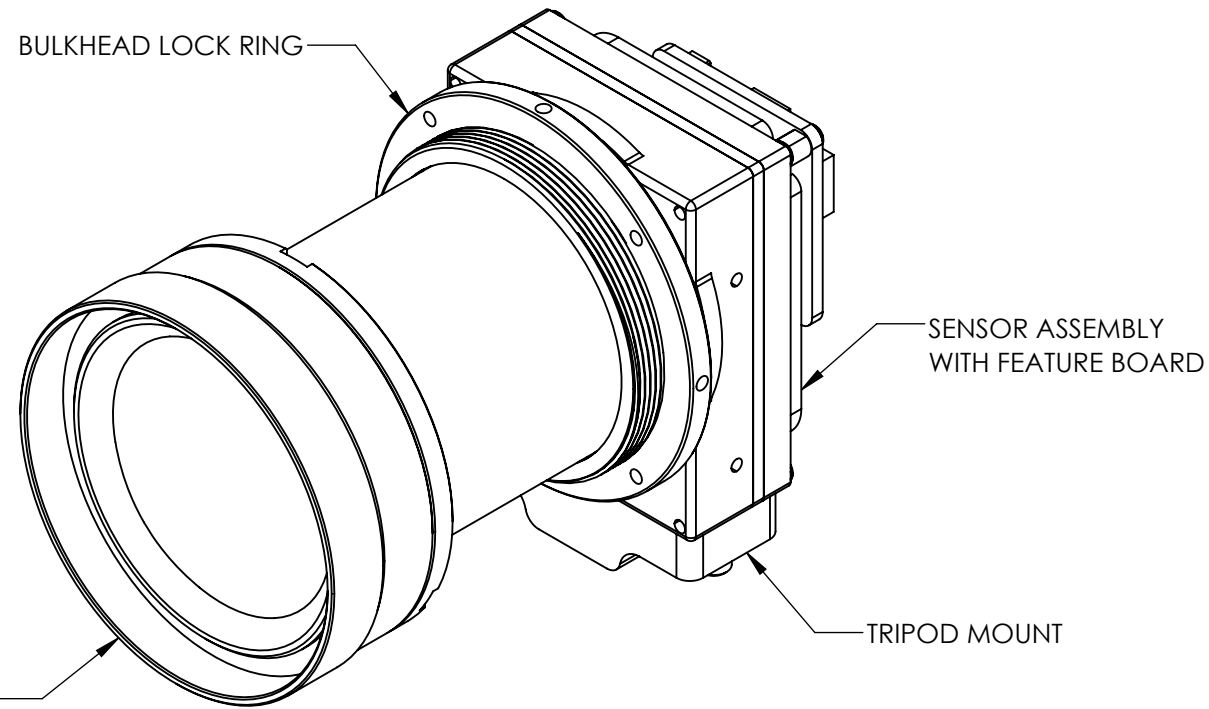

RIGHT VIEW

SL-D5-1321-A70
 VIENTO HD10 WITH FEATURE BOARD, LM, 70DEG HFOV, 9.2MM
 MASS = 187 GRAMS

Product Export Classification Control Number(ECCN): 60/30Hz 6A003.b.4.b 9Hz: 6A993	UNLESS OTHERWISE SPECIFIED DIM ARE IN MILLIMETERS	PROPRIETARY AND CONFIDENTIAL THE INFORMATION CONTAINED IN THIS DRAWING IS THE SOLE PROPERTY OF SIERRA OLYMPIA TECHNOLOGIES, INC. ANY REPRODUCTION IN PART OR AS A WHOLE WITHOUT THE WRITTEN PERMISSION OF SIERRA OLYMPIA TECHNOLOGIES, INC. IS PROHIBITED.
This document does not contain export-controlled technology.	X ± 2.5 mm	MATERIAL: N/A
	X.X ± 0.3 mm	
	ANGLES X ± 1°	FINISH: N/A
	X.XX ± 0.13 mm	
	THIRD ANGLE PROJECTION	DRAWING NUMBER: 20-70114
	DO NOT SCALE DRAWING	Rev. A

SIERRA-OLYMPIA TECHNOLOGIES INC.	
DESCRIPTION: MECHANICAL ICD, VIENTO HD10, 70DEG HFOV, 9.2mm	
SIZE B	DRAWN BY: M. SCOTT
SHEET 2 OF 8	

ESTIMATED POWER DRAW IS 4.6W STEADY-STATE.
 CONDUCTIVE OR CONVECTIVE THERMAL DISSIPATION
 IS RECOMMENDED
 FOR ADDITIONAL CONNECTOR INFORMATION REFERENCE
 ELECTRICAL ICD DOC 20-70068

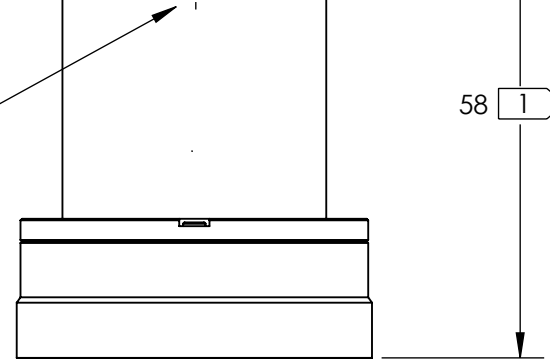
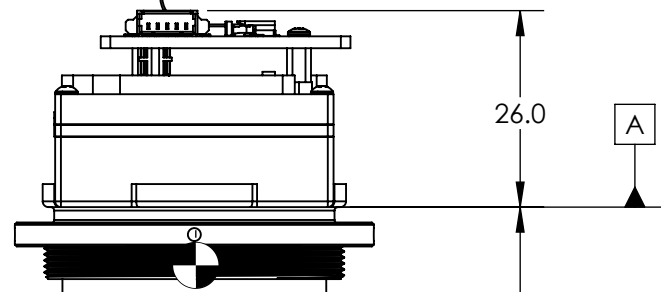
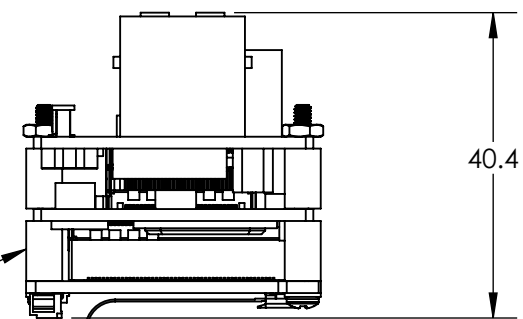

TOP VIEW

$\phi 47.50$

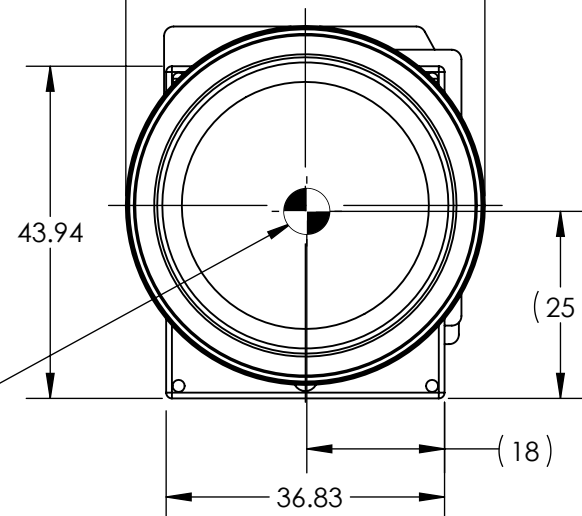

FRONT VIEW

APPROXIMATE
 CENTER OF GRAVITY

APPROXIMATE
 CENTER OF GRAVITY

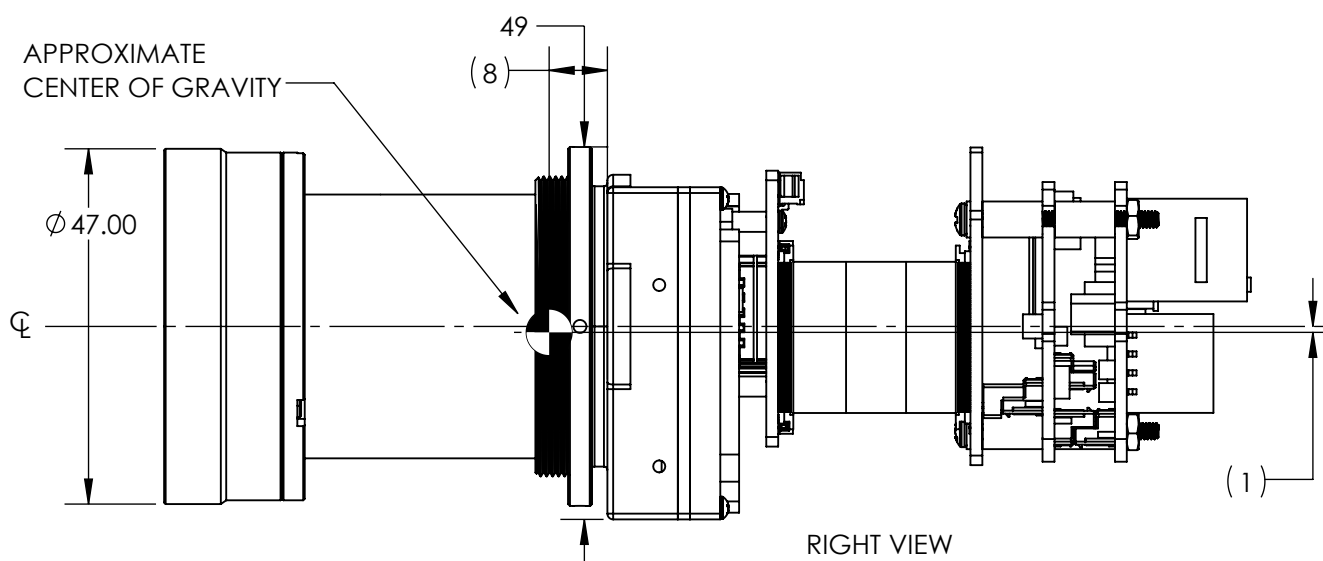
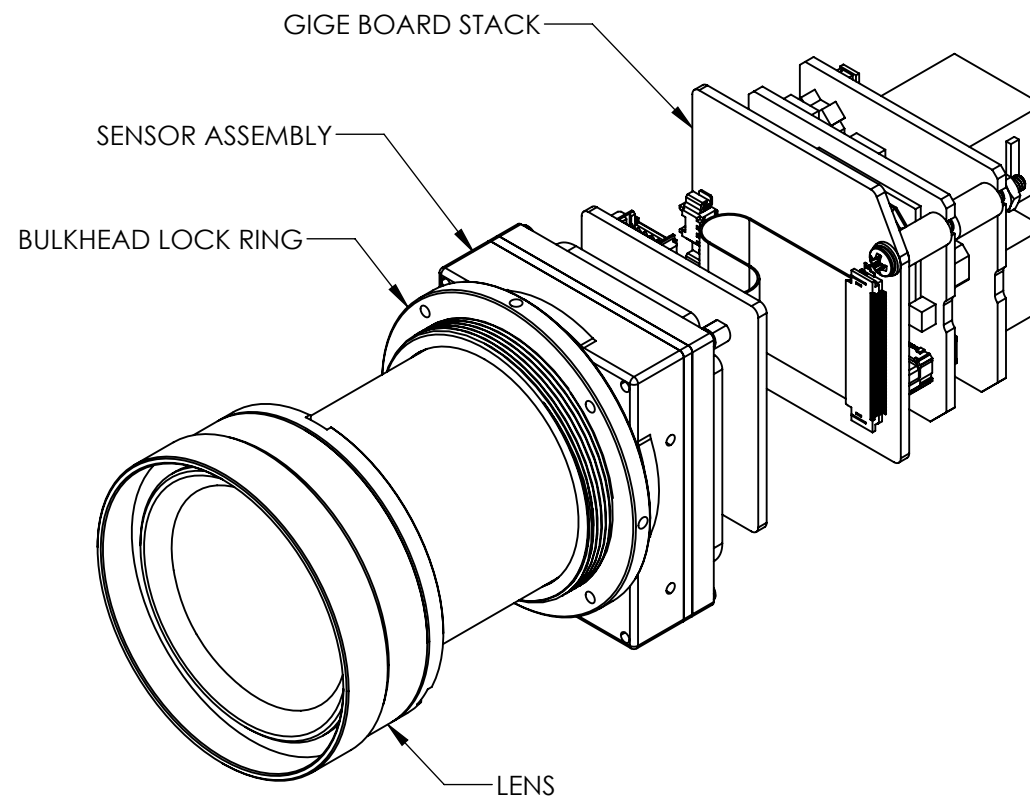

RIGHT VIEW

APPROXIMATE
 CENTER OF GRAVITY

SL-D5-1322-A70
 VIENTO HD10 GIGE, 70DEG HFOV, 9.2MM
 MASS = 217 GRAMS

Product Export Classification
 Control Number(ECCN):
 60/30Hz 6A003.b.4.b
 9Hz: 6A993

This document does not
 contain export-controlled
 technology.

UNLESS OTHERWISE SPECIFIED
 DIM ARE IN MILLIMETERS

X ± 2.5 mm	ANGLES
X.X ± 0.3 mm	X ± 1°
X.XX ± 0.13 mm	X.X ± 0.5°

THIRD ANGLE PROJECTION

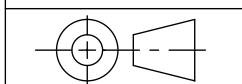

DO NOT SCALE DRAWING

PROPRIETARY AND CONFIDENTIAL
 THE INFORMATION CONTAINED IN THIS DRAWING IS THE SOLE
 PROPERTY OF SIERRA OLYMPIA TECHNOLOGIES, INC. ANY
 REPRODUCTION IN PART OR AS A WHOLE WITHOUT THE WRITTEN
 PERMISSION OF SIERRA OLYMPIA TECHNOLOGIES, INC. IS PROHIBITED.

MATERIAL:
 N/A

FINISH:
 N/A

N/A

SIERRA-OLYMPIA
 TECHNOLOGIES INC.

DESCRIPTION:
 MECHANICAL ICD, VIENTO HD10,
 70DEG HFOV, 9.2mm

SIZE: **B** DRAWN BY: M. SCOTT SHEET 3 OF 8

DRAWING NUMBER: 20-70114 Rev. A

ESTIMATED POWER DRAW IS 2.5W STEADY-STATE.
 CONDUCTIVE OR CONVECTIVE THERMAL DISSIPATION
 IS RECOMMENDED
 FOR ADDITIONAL CONNECTOR INFORMATION REFERENCE
 ELECTRICAL ICD DOC S-D11285

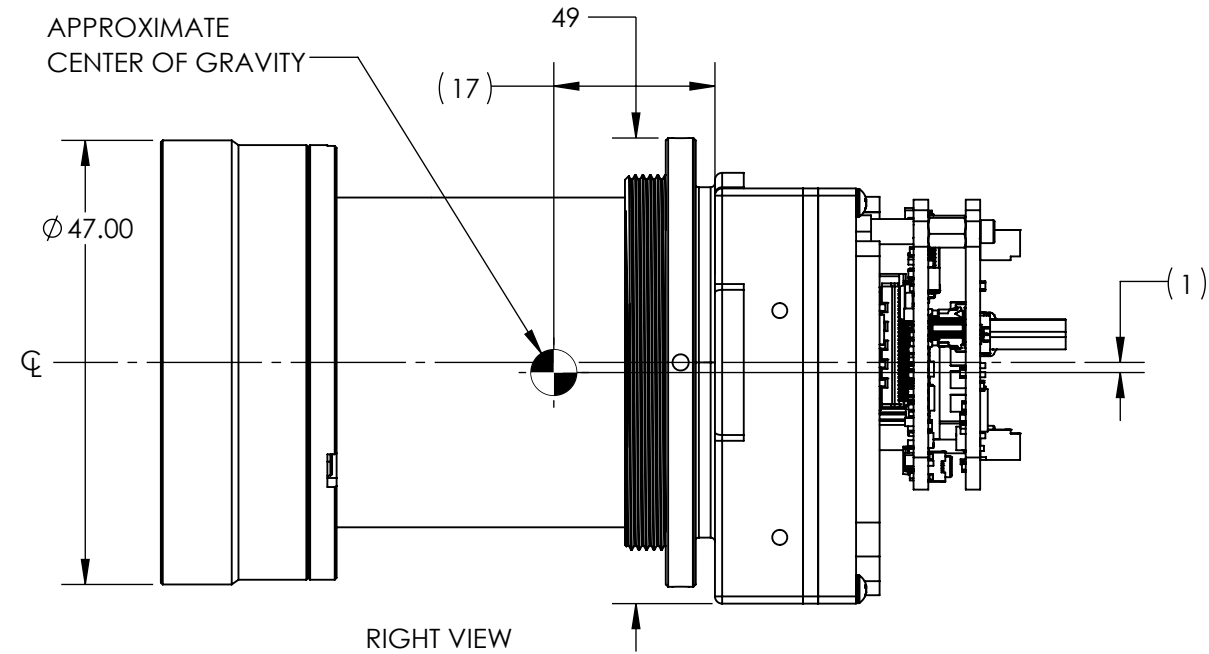
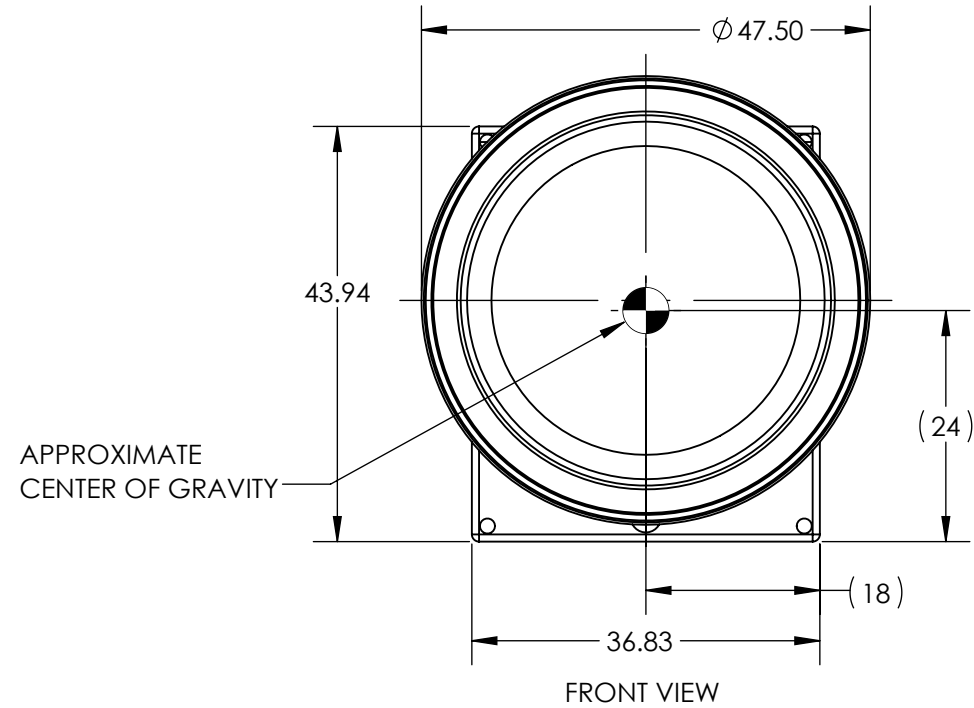
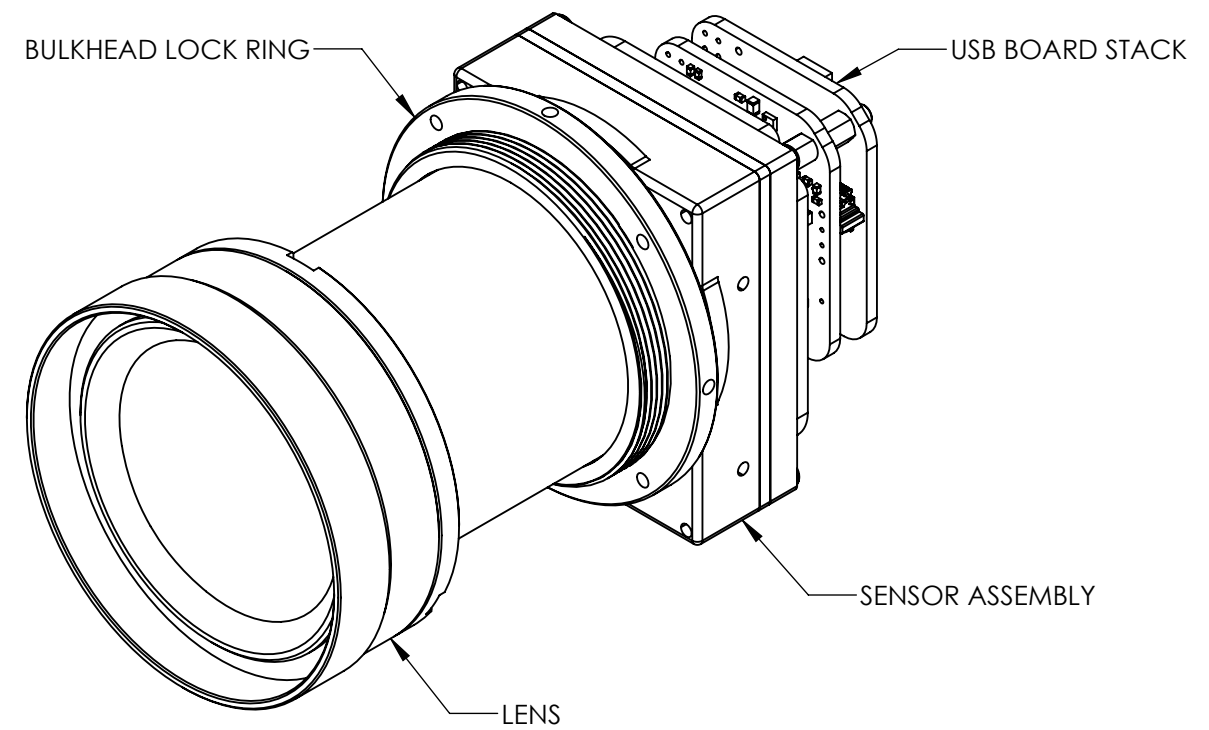
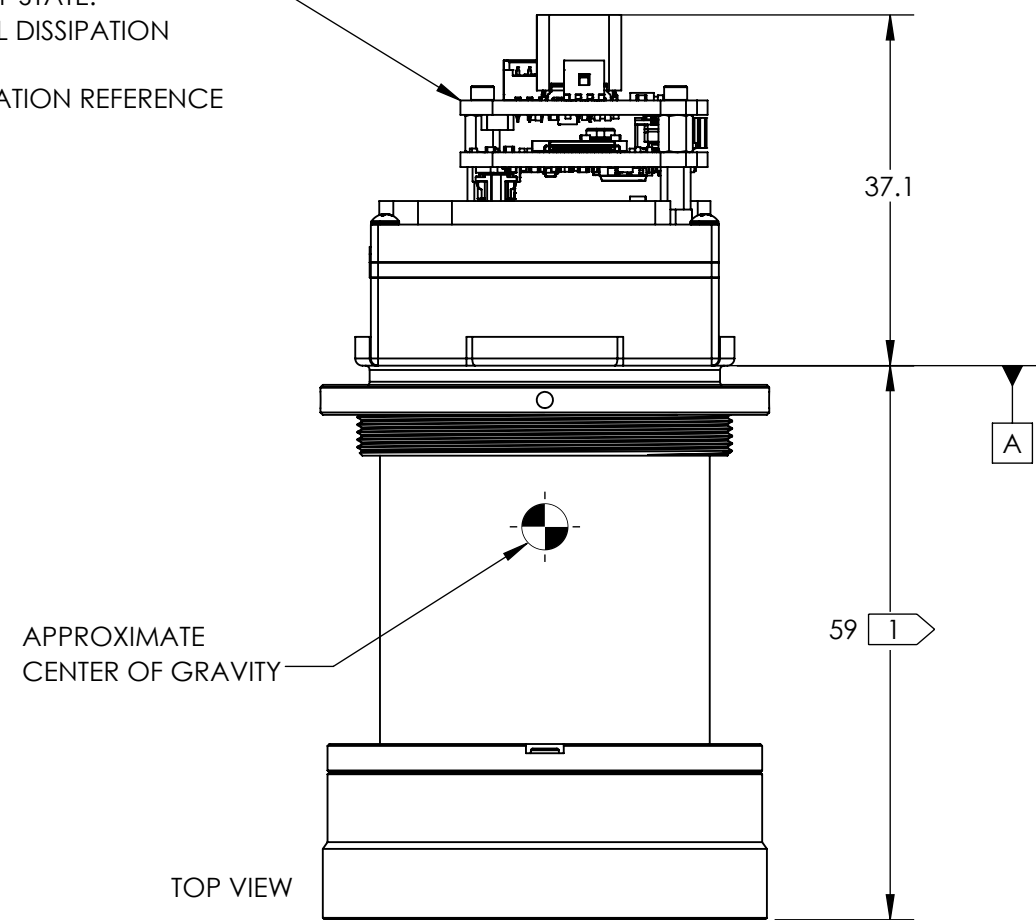

SL-D5-1324-A70
 VIENTO HD10 USB, 70DEG HFOV, 9.2MM
 MASS = 176 GRAMS

Product Export Classification Control Number(ECCN): 60/30Hz 6A003.b.4.b 9Hz: 6A993 This document does not contain export-controlled technology.	UNLESS OTHERWISE SPECIFIED DIM ARE IN MILLIMETERS		PROPRIETARY AND CONFIDENTIAL THE INFORMATION CONTAINED IN THIS DRAWING IS THE SOLE PROPERTY OF SIERRA OLYMPIA TECHNOLOGIES, INC. ANY REPRODUCTION IN PART OR AS A WHOLE WITHOUT THE WRITTEN PERMISSION OF SIERRA OLYMPIA TECHNOLOGIES, INC. IS PROHIBITED. MATERIAL: N/A FINISH: N/A N/A	SIERRA-OLYMPIA TECHNOLOGIES INC.		
	X ± 2.5 mm	ANGLES X ± 1°		DESCRIPTION: MECHANICAL ICD, VIENTO HD10, 70DEG HFOV, 9.2mm		
	X.X ± 0.3 mm	X ± 0.5°		SIZE	DRAWN BY:	SHEET 4 OF 8
	X.XX ± 0.13 mm	X.X ± 0.5°		B	M. SCOTT	
THIRD ANGLE PROJECTION			DRAWING NUMBER:		20-70114	
			Rev. A			
DO NOT SCALE DRAWING						

ESTIMATED POWER DRAW IS 4.1W STEADY-STATE.
 CONDUCTIVE OR CONVECTIVE THERMAL DISSIPATION
 IS RECOMMENDED
 FOR ADDITIONAL CONNECTOR INFORMATION REFERENCE
 ELECTRICAL ICD DOC 20-70054

APPROXIMATE
 CENTER OF GRAVITY

TOP VIEW

APPROXIMATE
 CENTER OF GRAVITY

FRONT VIEW

BULKHEAD LOCK RING

SDI BOARD STACK

SENSOR ASSEMBLY

LENS

APPROXIMATE
 CENTER OF GRAVITY

RIGHT VIEW

SL-D5-1326-A70
 VIENTO HD10 SDI, 70DEG HFOV, 9.2MM
 MASS = 184 GRAMS

Product Export Classification
 Control Number(ECCN):
 60/30Hz 6A003.b.4.b
 9Hz: 6A993

This document does not
 contain export-controlled
 technology.

UNLESS OTHERWISE SPECIFIED
 DIM ARE IN MILLIMETERS

X ± 2.5 mm	ANGLES X ± 1°
X.X ± 0.3 mm	X.X ± 0.5°
X.XX ± 0.13 mm	

THIRD ANGLE PROJECTION

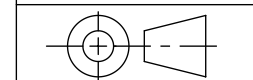

DO NOT SCALE DRAWING

PROPRIETARY AND CONFIDENTIAL
 THE INFORMATION CONTAINED IN THIS DRAWING IS THE SOLE
 PROPERTY OF SIERRA OLYMPIA TECHNOLOGIES, INC. ANY
 REPRODUCTION IN PART OR AS A WHOLE WITHOUT THE WRITTEN
 PERMISSION OF SIERRA OLYMPIA TECHNOLOGIES, INC. IS PROHIBITED.

MATERIAL:
 N/A

FINISH:
 N/A

N/A

SIERRA-OLYMPIA
 TECHNOLOGIES INC.

DESCRIPTION:
 MECHANICAL ICD, VIENTO HD10,
 70DEG HFOV, 9.2mm

SIZE B	DRAWN BY: M. SCOTT	SHEET 5 OF 8
------------------	-----------------------	--------------

DRAWING NUMBER: 20-70114	Rev. A
-----------------------------	--------

ESTIMATED POWER DRAW IS 3.1W STEADY-STATE.
 CONDUCTIVE OR CONVECTIVE THERMAL DISSIPATION
 IS RECOMMENDED
 FOR ADDITIONAL CONNECTOR INFORMATION REFERENCE
 ELECTRICAL ICD DOC 20-70060

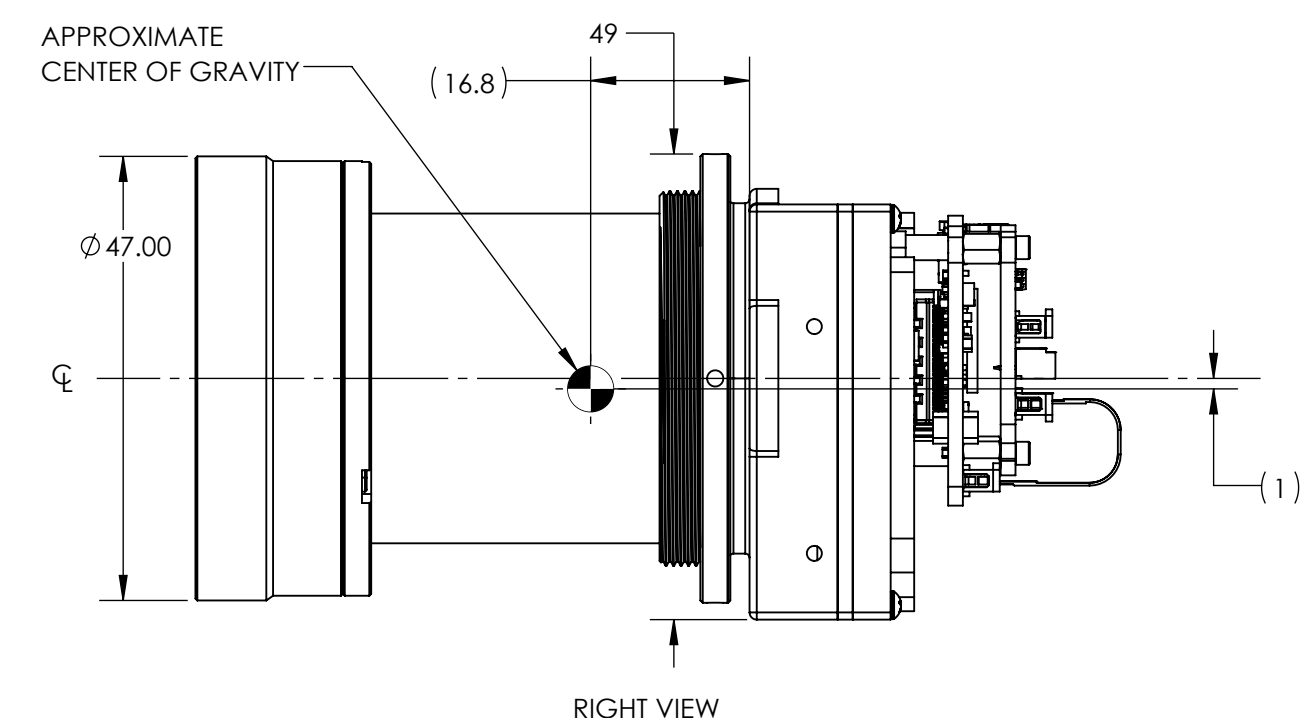
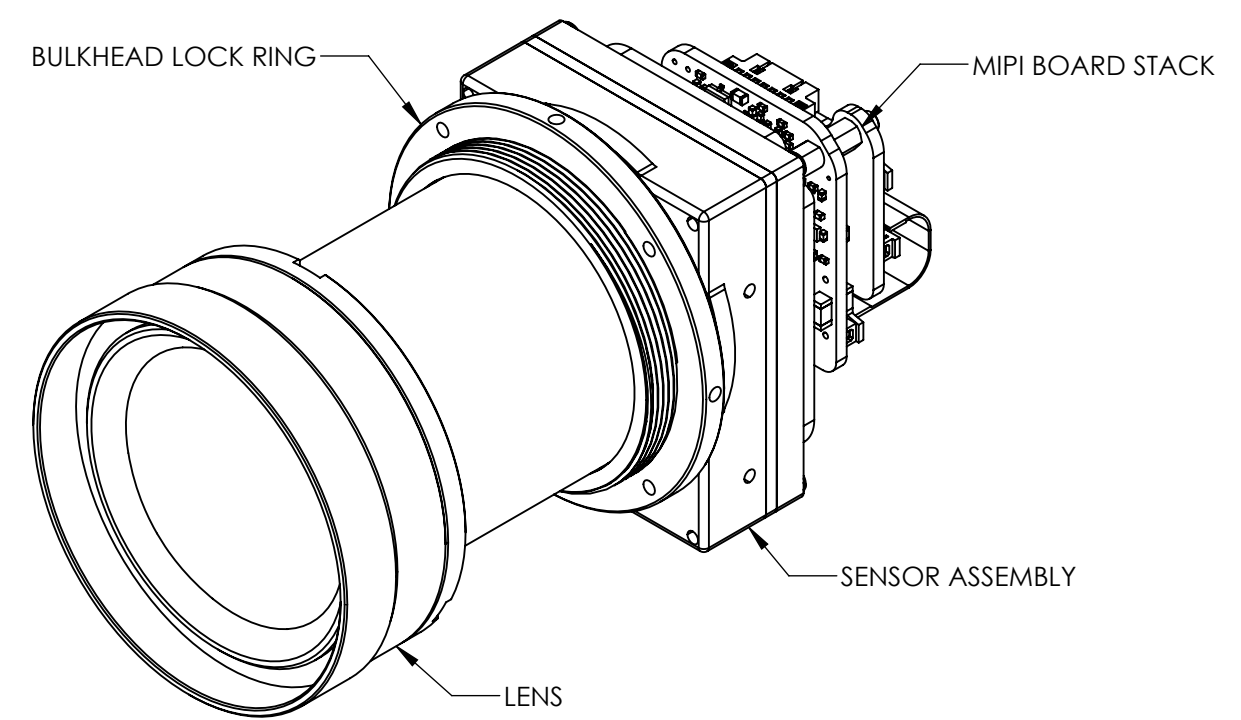
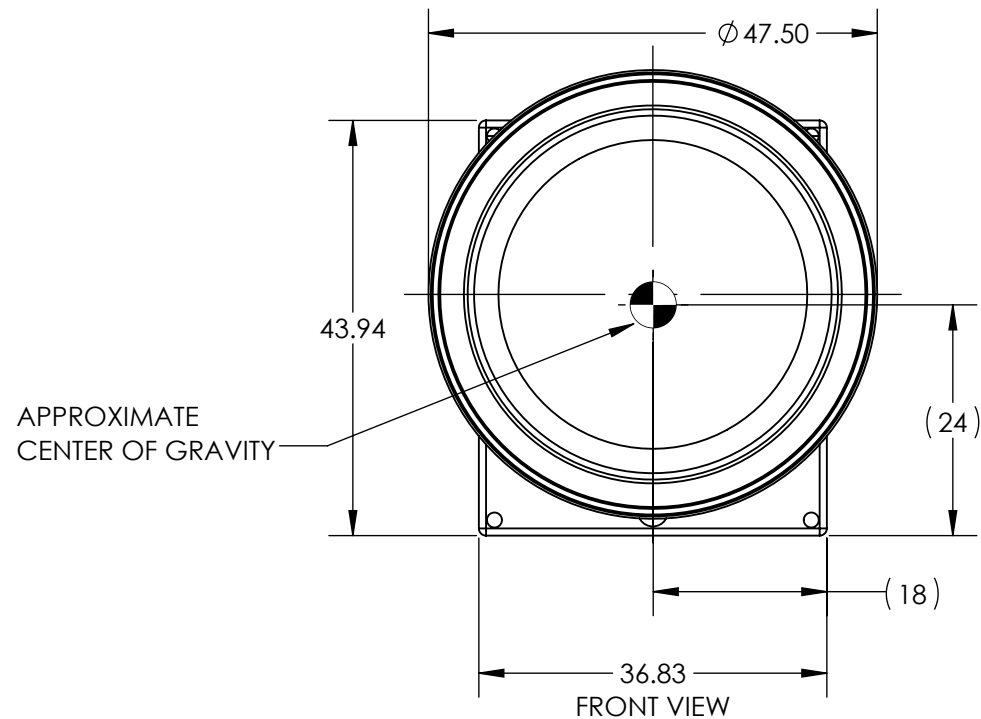
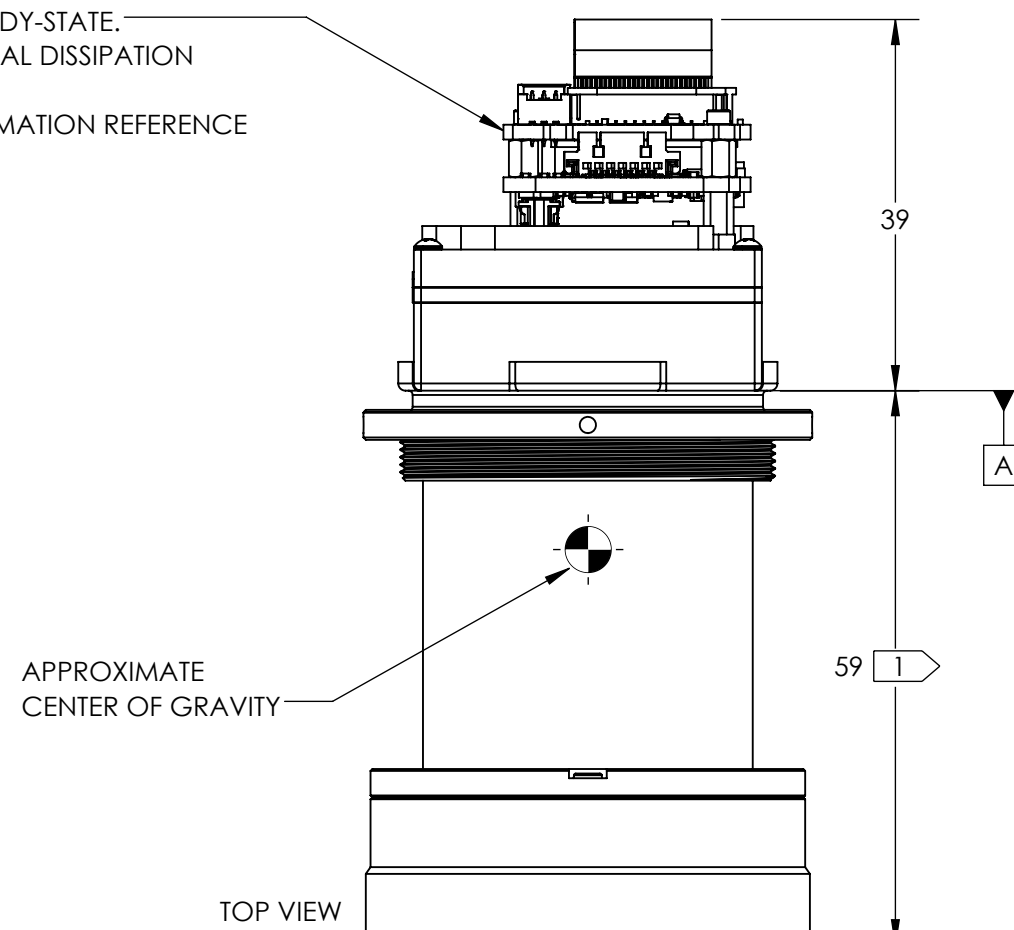

SL-D5-1328-A70
 VIENTO HD10 MIPI, 70DEG HFOV, 9.2MM
 MASS = 176 GRAMS

Product Export Classification Control Number(ECCN): 60/30Hz 6A003.b.4.b 9Hz: 6A993 This document does not contain export-controlled technology.	UNLESS OTHERWISE SPECIFIED DIM ARE IN MILLIMETERS		PROPRIETARY AND CONFIDENTIAL THE INFORMATION CONTAINED IN THIS DRAWING IS THE SOLE PROPERTY OF SIERRA OLYMPIA TECHNOLOGIES, INC. ANY REPRODUCTION IN PART OR AS A WHOLE WITHOUT THE WRITTEN PERMISSION OF SIERRA OLYMPIA TECHNOLOGIES, INC. IS PROHIBITED. MATERIAL: N/A FINISH: N/A N/A
	X ± 2.5 mm	ANGLES	
	X.X ± 0.3 mm	X ± 1°	
	X.XX ± 0.13 mm	X.X ± 0.5°	
THIRD ANGLE PROJECTION			
DO NOT SCALE DRAWING			

		DESCRIPTION:
		MECHANICAL ICD, VIENTO HD10, 70DEG HFOV, 9.2mm
SIZE	DRAWN BY:	SHEET 6 OF 8
B	M. SCOTT	
DRAWING NUMBER:		Rev. A
20-70114		

O RING GROOVE
M34 X 0.5-6H
INTERNAL THREAD

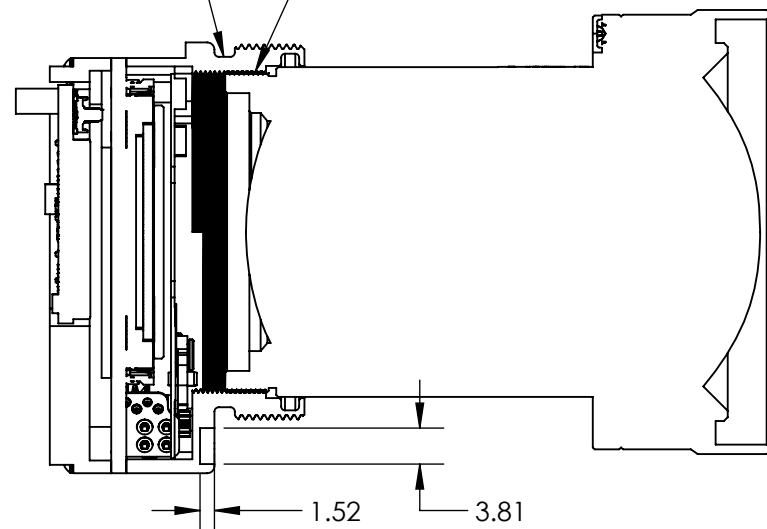

SECTION A-A

4 4X M2 X 0.4-6H ∇ 3.0

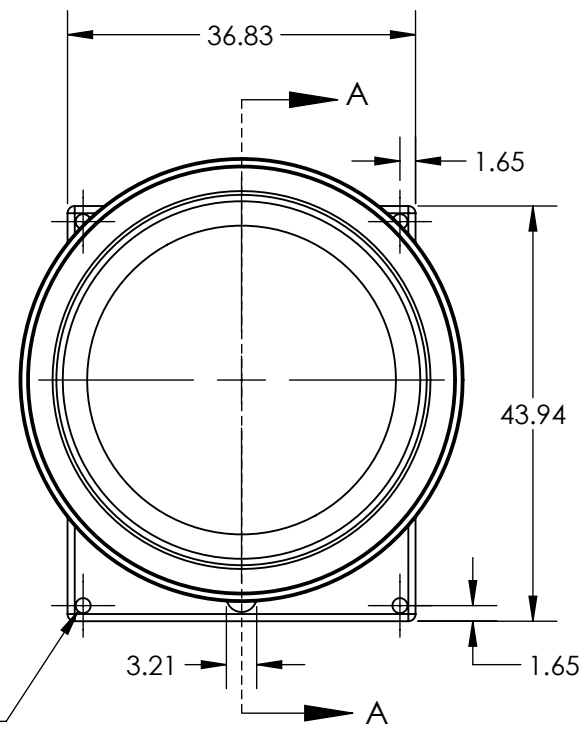

FRONT VIEW (LOCKRING REMOVED FOR CLARITY)

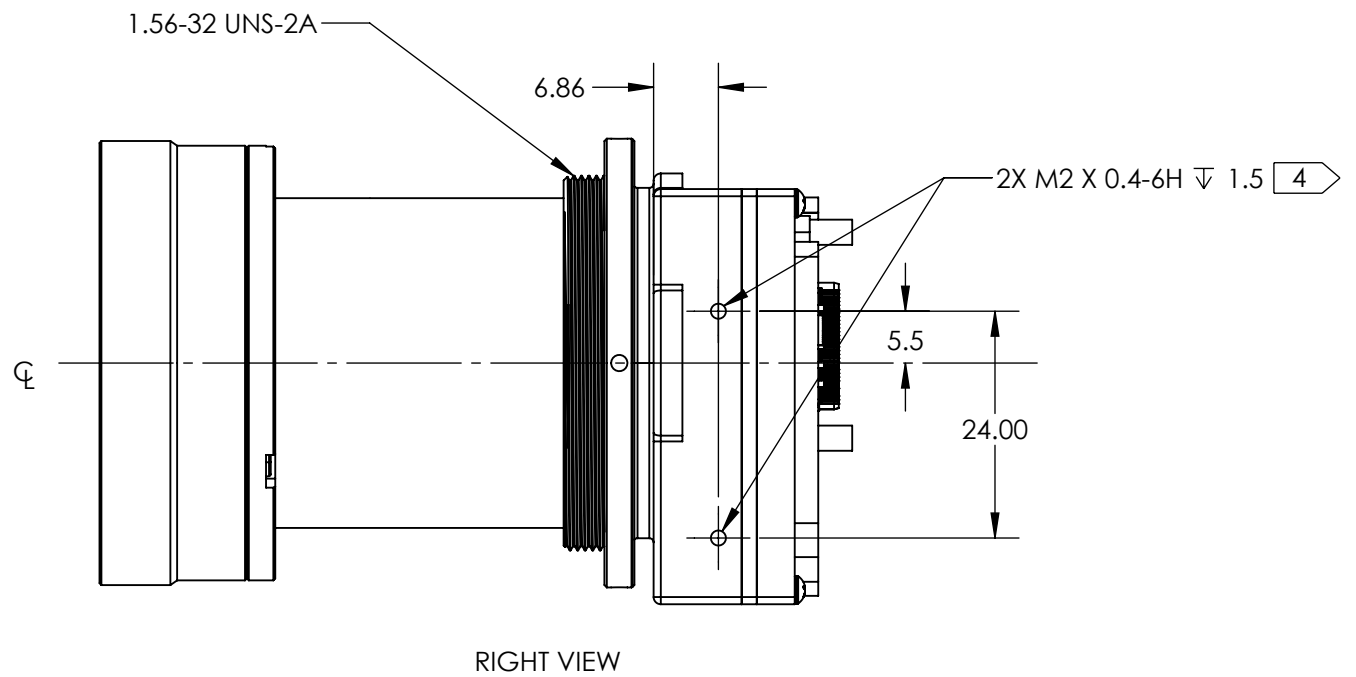

RIGHT VIEW

NOTE: REMOVAL AND REINSTALLATION
OF LENS. FOD RISK

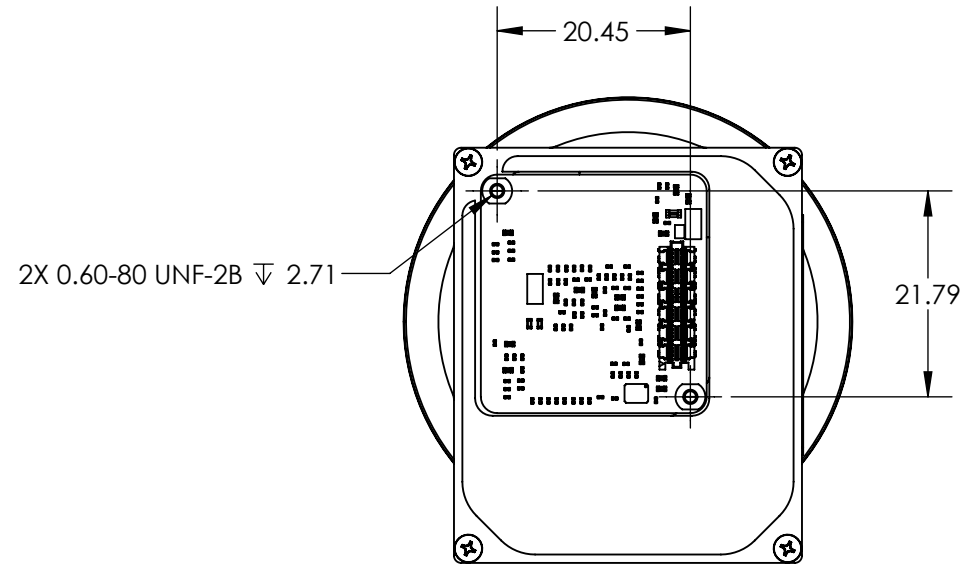

BACK VIEW

2X 0.60-80 UNF-2B ∇ 2.71

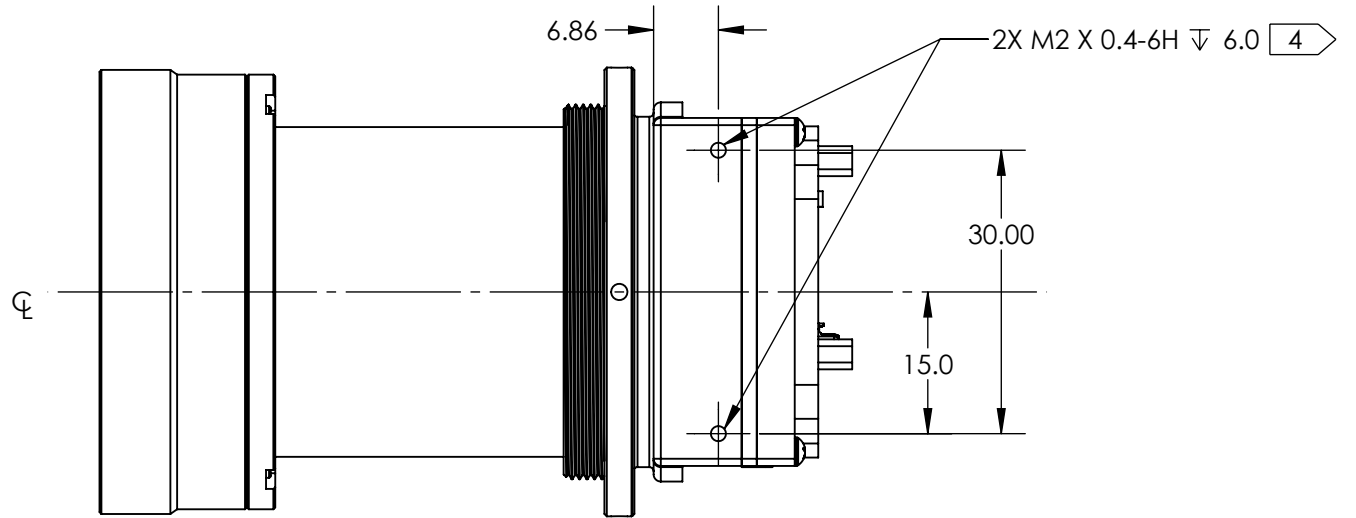

BOTTOM VIEW

Product Export Classification Control Number(ECCN): 60/30Hz 6A003.b.4.b 9Hz: 6A993 This document does not contain export-controlled technology.	UNLESS OTHERWISE SPECIFIED DIM ARE IN MILLIMETERS		PROPRIETARY AND CONFIDENTIAL THE INFORMATION CONTAINED IN THIS DRAWING IS THE SOLE PROPERTY OF SIERRA OLYMPIA TECHNOLOGIES, INC. ANY REPRODUCTION IN PART OR AS A WHOLE WITHOUT THE WRITTEN PERMISSION OF SIERRA OLYMPIA TECHNOLOGIES, INC. IS PROHIBITED.	SIERRA-OLYMPIA TECHNOLOGIES INC.		
	X ± 2.5 mm	ANGLES X ± 1°				DESCRIPTION: MECHANICAL ICD, VIENTO HD10, 70DEG HFOV, 9.2mm
	X.X ± 0.3 mm	X ± 1°		SIZE B	DRAWN BY: M. SCOTT	SHEET 7 OF 8
	X.XX ± 0.13 mm	X.X ± 0.5°		DRAWING NUMBER: 20-70114		Rev. A
THIRD ANGLE PROJECTION		MATERIAL: N/A				
		FINISH: N/A				
DO NOT SCALE DRAWING		N/A				

4

3

2

1

FIELDS OF VIEW ENTRANCE PUPIL LOCATION 14.5mm BEHIND LENS VERTEX ENTRANCE PUPIL DIAMETER: 9.2mm	
VFOV	58.3°
HFOV	70.0°
DFOV	84.4°

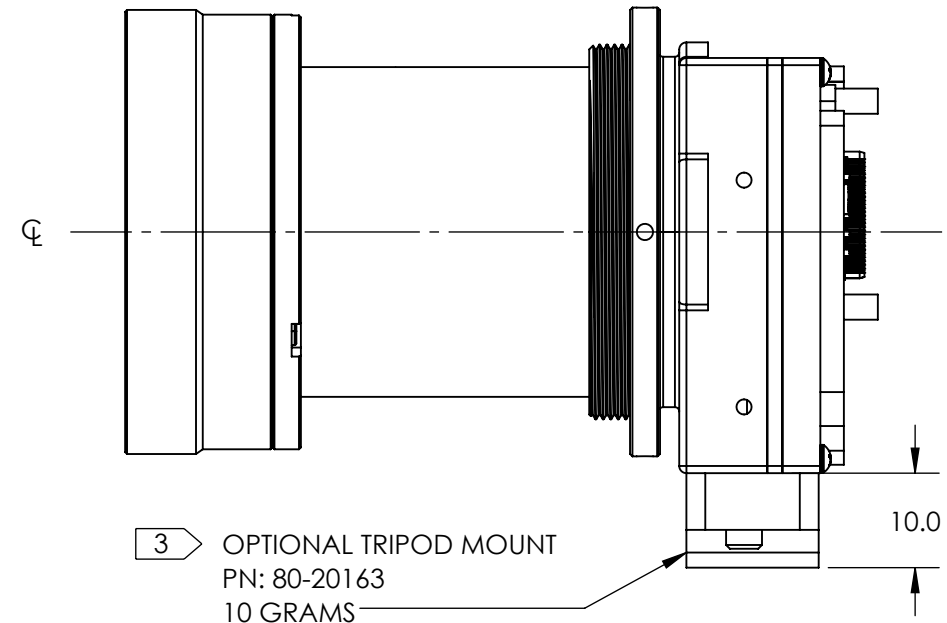

RIGHT VIEW WITH REMOVABLE TRIPOD MOUNT AND REMOVABLE LENS CAP

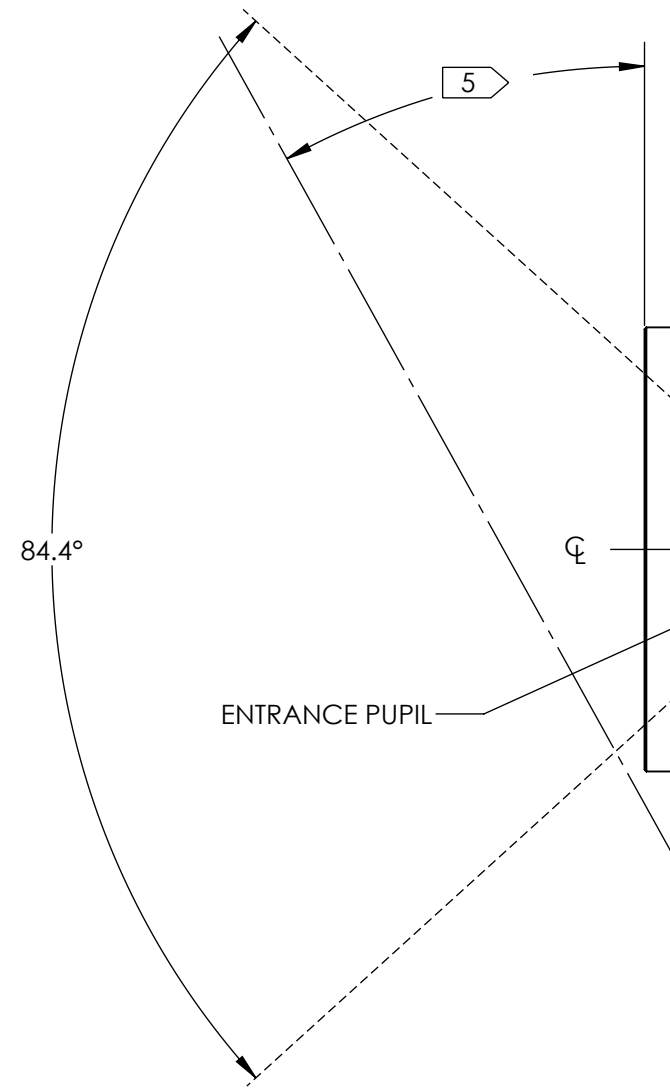

ENTRANCE PUPIL

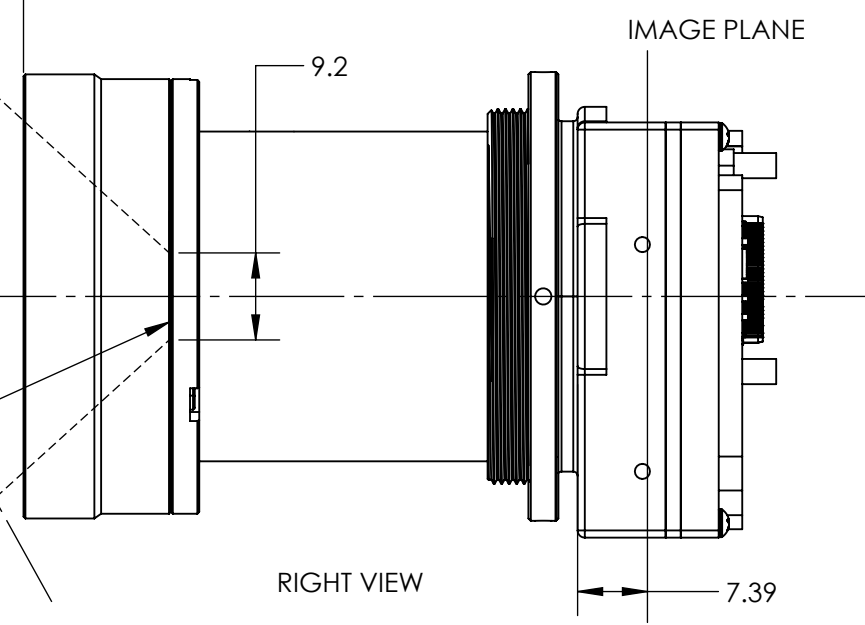

RIGHT VIEW

IMAGE PLANE

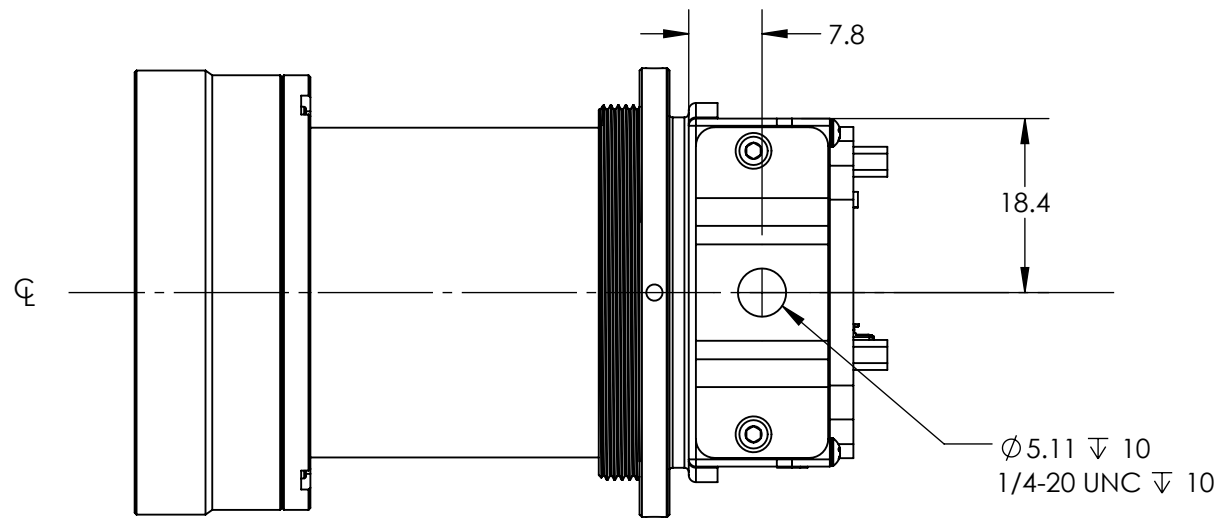

BOTTOM VIEW WITH REMOVABLE TRIPOD MOUNT AND REMOVABLE LENS CAP

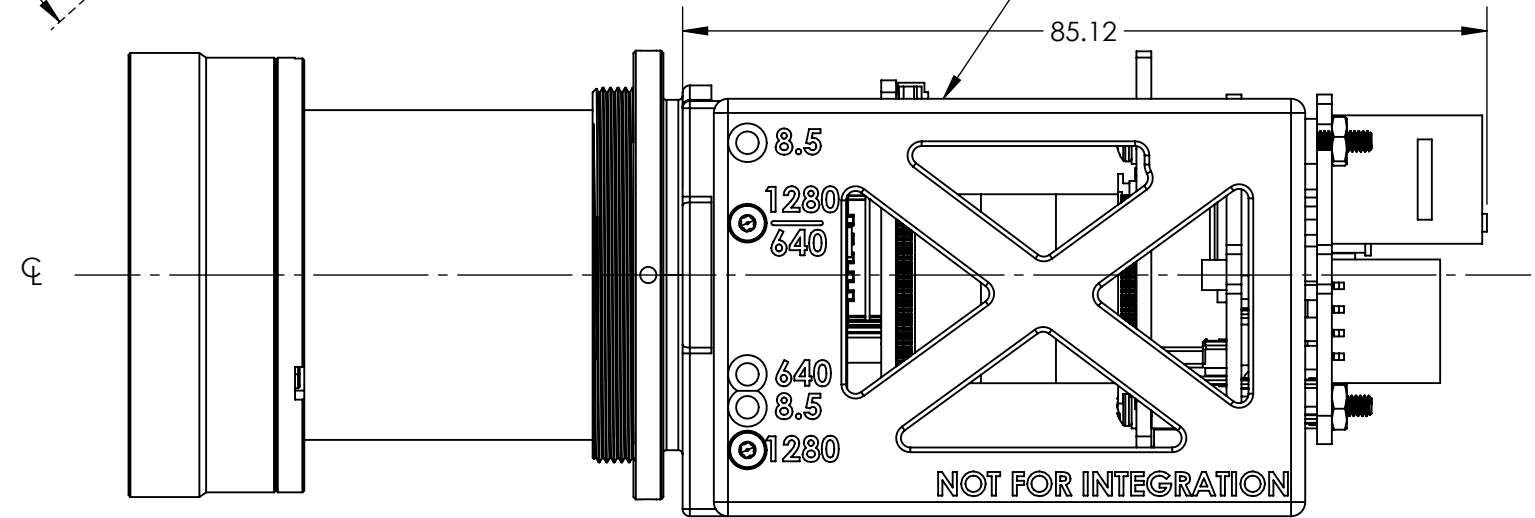

RIGHT VIEW WITH REMOVABLE GIGE SHIPPING BRACKET

Product Export Classification Control Number(ECCN): 60/30Hz 6A003.b.4.b 9Hz: 6A993 This document does not contain export-controlled technology.	UNLESS OTHERWISE SPECIFIED DIM ARE IN MILLIMETERS		PROPRIETARY AND CONFIDENTIAL THE INFORMATION CONTAINED IN THIS DRAWING IS THE SOLE PROPERTY OF SIERRA OLYMPIA TECHNOLOGIES, INC. ANY REPRODUCTION IN PART OR AS A WHOLE WITHOUT THE WRITTEN PERMISSION OF SIERRA OLYMPIA TECHNOLOGIES, INC. IS PROHIBITED. MATERIAL: N/A FINISH: N/A N/A		SIERRA-OLYMPIA TECHNOLOGIES INC. DESCRIPTION: MECHANICAL ICD, VIENTO HD10, 70DEG HFOV, 9.2mm SIZE: B DRAWN BY: M. SCOTT SHEET 8 OF 8 DRAWING NUMBER: 20-70114 Rev. A
	X ± 2.5 mm	ANGLES X ± 1°			
	X.X ± 0.3 mm	X.X ± 0.5°			
	X.XX ± 0.13 mm				
THIRD ANGLE PROJECTION					
DO NOT SCALE DRAWING					

4

3

2

1